



Excellence on board



PRODUCT CATALOG

index

Company profile	4 - 5
World wide sales and service	6 - 7
Refrigeration	8 - 13
AC/DC Models	10 - 12
Portable Refrigeration	13
Sanitation	14 - 15
How it works	16 - 19
Technical specifications	18 - 19
Sanitation product overview	20 - 25
Design line > 100 ft	26 - 37
X-Light, X-Light Short	28 - 29
Privilege	30 - 31
Evolution	32 - 33
E-Breeze	34 - 37
Flexi line 50-100 ft	38 - 47
Flexi line 2G	40 - 43
Silence Plus 2G, Silence Plus 2G Short	44 - 45
Silence 2G, Silence 2G Short	46 - 47
Compact line 20-50 ft	48 - 55
Nano	50 - 51
Compass, Compass Short	52 - 53
Easy Fit, Easy Fit Short	54 - 55
How to Order	56 - 59
What you need to order to receive a functioning toilet	56 - 57
Menu Ordering SKUs	58 - 59
Portable line < 30 ft	60 - 63
Porta Potti 565E	62
Porta Potti 365, 345, 135/335	63
Holding tank care	64 - 67
Holding tank deodorants & cleaner	66 - 67
Toilet tissue	67
Components and accessories	68 - 73
Control panels for every bathroom	70 - 72
Accessories	73
Sanisplit grey water transfer systems	74 - 75
Sanitation hoses	76 - 77
System set up	78 - 82

THETFORD MARINE IS THE TEAM YOU CAN RELY ON!



Company profile

The Thetford Group for the last 50 years has been recognized as the world market leader in mobile sanitation systems, refrigerators, cooking equipment and sanitation additives. Thetford Marine as the nautical division, has a complete and marine-dedicated product line consisting of the strong brands of Tecma for sanitation, Thetford for portable sanitation and Norcold for refrigeration.

The marine world is one of sophisticated equipment, beautiful design and impressive performance. Boat designers, builders, owners, crews, and users all have a vested interest in the smooth operation and management of their vessel. At Thetford Marine we understand the requirements and the need for flexibility to perfectly match the product to your yacht and situation.

Being your partner you're guaranteed of

- Reliable partner
- Long-term relationship
- Service oriented
- Extensive know-how, built on long experience and dedication
- Experienced Italian design team
- Maximum flexibility

GLOBAL SALES, LOCAL SERVICE





World wide sales and service network

As an experienced full system supplier, Thetford Marine understands the needs of OEM, yards, architects and yachtsmen, therefore our products are globally available thanks to our extensive and reliable worldwide distribution network.

Thetford Marine understands that buyers and users of marine equipment occasionally have to service their equipment. This must be convenient and fast. Our large network of Thetford Marine Service locations are located across the world and offer professional support, stocks of spare parts and immediate in-port response. Thetford Marine offers a three-year warranty on Thetford sanitation products. The Tecma and Norcold product lines have a two-year warranty.

Find your nearest sales or service locations online at www.thetfordmarine.com.



NOVA  KOOL

REFRIGERATION – RELIABILITY ON THE MOVE



Norcold silent refrigerators will keep your provisions fresh, tasty and reliably cool whatever the outside temperature.

Quiet, dependable, and designed to last for years, our compressor refrigerators are ideal for marine applications. Thetford offers a comprehensive line of top performing compressor refrigerators, working on both DC and AC. Top of the line is the 0061, a two door model with contemporary flush mount styling. This is the coolest unit we offer: with a large freezer separated from an even larger refrigerator.

Benefits

- Exceptionally quiet, hermetically sealed compressor
- Improved cooling performance in higher ambient temperatures
- Designed specifically for marine purposes
- Durable, easy to clean white powder coated shelves
- Clean, modern, finish

NOVA KOOL

NOVAKOOL MARINE REFRIGERATION

Safe, Efficient, Quiet, Reliable

For more information check

www.novakool.com

	NR751	NR740	0061	0041	DE105
					
Cutout dimensions H x W x D (in)	20.5 x 18.5 x 21.0625	20.5 x 15.25 x 20.5	52.875 x 23.25 x 23.75	30.75 x 23.25 x 23.5	30 x 20.75 x 20.125
Flush mount depth (in)	23.1875	19.9375	N/A	N/A	21.5
Storage capacity	2.7 cu. ft.	1.7 cu. ft.	7.0 cu. ft.	3.6 cu. ft.	3.3 cu. ft.
Net Weight (lb)	49	41	95	65	70
Shipping Weight (lb)	53	45	115	80	76
Fridge door options	BB = Black trim and insert panel SS = Grey trim and stainless insert panel	BB = Black trim and insert panel SS = Grey trim and stainless insert panel	BB = Black trim and insert panel SS = N/A	BB = Black trim and insert panel SS = N/A	B = Black door panel
Power source DC (volts / amp draw)	12 VDC / 3.6 A 24 VDC / 1.8 A	12 VDC / 3.6 A 24 VDC / 1.8 A	12 VAC / 5.9 A (US/CAN/EU) 24 VAC / 2.4 A (US/CAN/EU)	12 VAC / 5.9 A (US/CAN/EU) 24 VAC / 2.4 A (US/CAN/EU)	12 VDC / 5.2 A 24 VDC / 2.6 A
Power source AC (volts / amp draw)	With optional power cord: 120 V / 0.75 A (US/CAN) 230 V / 0.47 A (EU/AU/NZ)	With optional power cord: 120 V / 0.75 A (US/CAN) 230 V / 0.47 A (EU/AU/NZ)	120 VAC / 0.8 A (US/CAN) 230 VAC / 0.4 A (EU)	120 VAC / 0.8 A (US/CAN) 230 VAC / 0.4 A (EU)	120 VAC / 60Hz / 0.9 A (US/CAN)

More information on pages 10 - 12.

NR751 / NR740

AC/DC Models

NR751 • 2.7 cu. ft.

NR740 • 1.7 cu. ft.

- Perfectly refits Norcold DE-0740/0751
- Danfoss BD35 compressor improves performance, especially at higher ambient temperatures
- LED interior light
- Improved styling - new “hidden” ventilation grill
- Fewer SKUs help streamline your product mix
- Base model is 12/24V DC - Optional Power Cord allows for AC operation
- Freezer door
- Can be flush-or-proud mounted without additional hardware
- Self-venting – a Norcold exclusive
- 2-year warranty

Model comparison on page 9.

Power Cords for NR751 and NR740

	Voltage	Amps	Description	Wt. (lb)
635591	120V	0.75	US AC Power Cord	2
635592	230V	0.47	EU AC Power Cord	2
635593	230V	0.47	AUS AC Power Cord	2



NR751SS



NR740BB

Information		Amp Draw				Proud H x W x D	Flush (D)
		12VDC	24VDC	120VAC	230VAC	Installation Dimensions (in)	Net / Carton Wt (lb)
NR751	BB = Black trim and door insert panel, SS = Grey trim and stainless door panel	3.6	1.8	-	-	20.5 x 18.25 x 21.06 [23.19]	49 / 53
NR751	Add a 635591 120V US Power Cord	3.6	1.8	0.75	-	20.5 x 18.25 x 21.06 [23.19]	49 / 53
NR751	Add either a 635592 230V EU Power Cord or 635593 Australian Power Cord	3.6	1.8	-	0.47	20.5 x 18.25 x 21.06 [23.19]	49 / 53
NR740	BB = Black trim and door insert panel, SS = Grey trim and stainless door panel	3.6	1.8	-	-	20.5 x 15.25 x 17.84 [19.96]	41 / 45
NR740	Add a 635591 120V US Power Cord	3.6	1.8	0.75	-	20.5 x 15.25 x 17.84 [19.96]	41 / 45
NR740	Add either a 635592 230V EU Power Cord or 635593 Australian Power Cord	3.6	1.8	-	0.47	20.5 x 15.25 x 17.84 [19.96]	41 / 45

Specifications subject to change.



Refrigeration

AC = Alternating Current (US/Canada): 120 Volts @ 60 hz
DC = Direct Current: 12 or 24 Volts
EV = European Voltage: 230 Volts AC @ 50 hz

0061 / 0041

AC/DC Models

0061 • 7.0 cu. ft.

- Top-of-the-line, two door model
- Now with Danfoss Compressor
- Contemporary Flushmount™ styling
- Self-ventilated design for easier integration
- Exceptionally quiet, hermetically-sealed compressor
- Drip tray drain hose – A 5-foot Extension Accessory Kit is available for the Drip Tray Drain Hose, Norcold Part #625127
- 12-volt fan aids airflow across condenser and compressor for improved cooling
- Reversible doors
- Black exterior trim with optional panel
- Storage for varied sizes, including 2-liter, 1/2-gallon and gallon containers
- Adjustable, removable, large container door bin storage
- Power cord included
- 2-year warranty



0041 • 3.6 cu. ft.

- Now with Danfoss Compressor
- Convenient top-mounted automatic temperature control
- Self-ventilated design for easier integration
- Contemporary Flushmount™ styling
- Black exterior trim with optional door panel
- Reversible doors with adjustable bins for various container sizes
- Convenient, easily-accessible large-container storage
- 12-volt fan aids airflow for improved cooling
- Power cord included
- 2-year warranty



Model comparison on page 9.

DE = Dual Electric: AC (Alternating Current US/Canada, 120 volts @ 60 Hz) AND DC (Direct Current, 12 or 24 Volts)

EV = European Voltage (230 Volts AC @ 50 Hz) AND DC (Direct Current, 12 or 24 Volts)

			Amp Draw				H x W x D	
	Information	Color	12VDC	24VDC	120VAC/60Hz	230V/50Hz	Installation Dimensions (in)	Net / Carton Wt (lb)
DE0061	Flush Mounted	Black Trim	5.9	2.4	0.80	-	52.875 x 23.25 x 23.75	98 / 115
EV0061	EU Certified Flush Mounted	Black Trim	5.9	2.4	-	0.40	52.875 x 23.25 x 23.75	98 / 115
DE0041	Flush Mounted	Black Trim	5.9	2.4	0.80	-	30.875 x 23.25 x 23.5	65 / 80
EV0041	EU Certified Flush Mounted	Black Trim	5.9	2.4	-	0.40	30.875 x 23.25 x 23.5	65 / 80

*Door panels not included. Black door panels available. DE0041: Part # 623866, DE0061: Part # 623867.

Specifications subject to change.

DE105

AC/DC Models

DE105 • 3.3 cu. ft.

- Combination Refrigerator/Freezer
- Two white powder-coated wire shelves with raised lip
- Dual clear door bins
- LED interior light
- Flush*, undercounter mounting
- 2-year warranty

Model comparison on page 9.

DE = Dual Electric: AC (Alternating Current US/Canada, 120 Volts @ 60 hz)
and DC (Direct Current, 12 or 24 Volts)

B = Black Door Panel



Information	Color	Amp Draw				Installation Dimensions (H x W x D)	Net / Carton Wt (lb)
		12VDC	24VDC	120VAC/60Hz	230VAC/50Hz		
DE105	Black Panel	5.2	2.6	0.9	N/A	30 x 20.75 x 20.125*	70 / 76

**Depth increases by 1.375" if installed with flush doors to the cabinet. Specifications subject to change.*



Refrigeration

PORTABLE REFRIGERATION

Convenient and durable

The perfect products for family outings, long trips, or just big appetites. A movable fridge always on hand!

Features

- Electronic temperature control panel displays the internal temperature and allows the user to set desired temperature
- CFC- free insulation foam and refrigerant
- Hermetically sealed compressor with built-in low voltage protection
- Easy reversible and removable hinge lid
- Simple to clean, removable wire basket for convenience
- Durable, corrosion resistant plastic exterior
- Heavy-duty removable handles
- Optional CCC-approved AC adapter
- Available in various sizes

Benefits

- Stainless steel interior prevents stains and improves cooling
- Separate 'refrigerator only' section prevents freezing of select items
- Battery protection with three adjustable levels, prevents battery drain and automatically turns back on when voltage returns
- Indicator light alerts you to installation issues

NRF-45



Optional AC Adaptor

Part # 634650



Removable wire basket



Electronic temperature control

NRF-60



NRF-45



NRF-30



Size (H x W x D) (in)	15.59 x 22.01 x 15.75	16.89 x 25.47 x 15.75	20.39 x 25.47 x 15.75
Weight (net)	49.6	44	39.6
Weight (carton)	57	52	46
Capacity (liters)	59	45	30
Capacity (quarts)	62	47	32
Capacity (cu. ft.)	2.1	1.6	1.1
Capacity (12 oz. cans)	86	64	42
Power consumption (watts)	55	50	45
Power options (volts / amp draw)	12 VDC / 5.3 A 24 VDC / 2.6 A 120 VAC / 0.5 A – with optional AC adaptor	12 VDC / 4.8 A 24 VDC / 2.4 A 120 VAC / 0.5 A – with optional AC adaptor	12 VDC / 4.3 A 24 VDC / 2.2 A 120 VAC / 0.4 A – with optional AC adaptor

Specifications subject to change.

TECMA

EXPERIENCE THE EXCELLENCE ON BOARD!

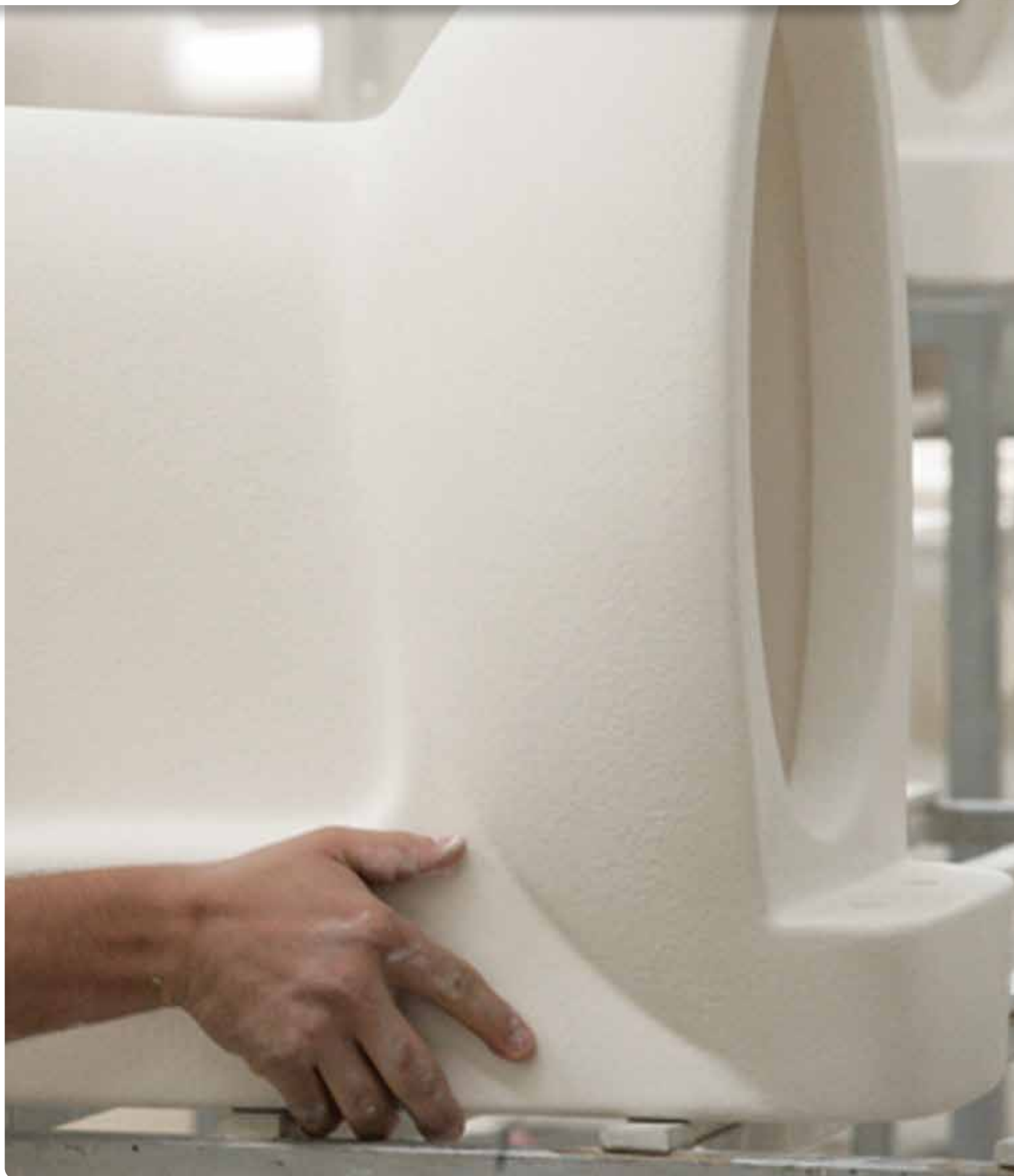

Beautiful boats deserve beautiful sanitary hardware

For those who design, build, own and charter boats, the beauty, performance and long term value of their product and their investment is paramount. At this juncture of uncompromising engineering and elegant styling the world of marine sanitation is a critical detail which has to perform trouble free. This is the world of Tecma, the macerator sanitation brand of Thetford Marine.

Benefits at a glance

Top design, quality components and production, uncompromising attitude and fast response to client needs have made Tecma the leading supplier of sanitation systems.

Tecma macerator toilets - the facts

- Over 100,000 Tecma macerator toilets onboard worldwide.
- Awarded and certified products (CE, TÜV-GS, CSA, MET).
- Inventor of the built-in macerator technology.
- 100% quality.

All Tecma macerator toilets have:

- State of the art of marine sanitation technology.
- Reliable operation.
- Extremely silent operation.
- Easy and fast installation.
- Water and power saving operations.



HOW IT WORKS

How it works

- 1 The water inlet device delivers clean water to the inside of the toilet bowl.
- 2 The macerator pump, integrated in the ceramic toilet, grinds the waste and then transfers it to the black water holding tank.
- 3 The flush cycle is activated by pressing the control panel buttons.

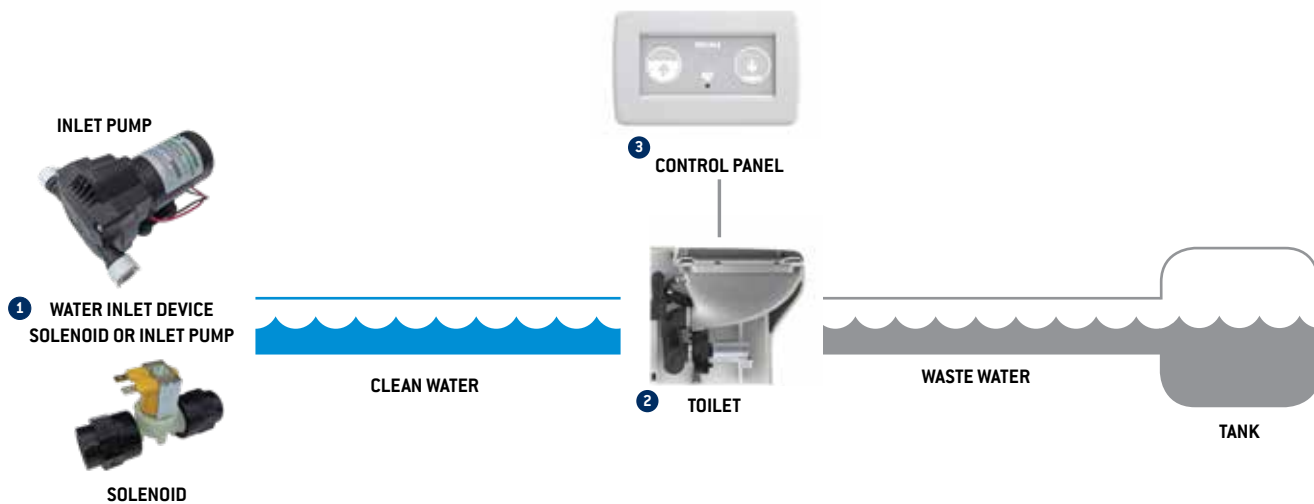

3 components with several possibilities

Each Tecma macerator toilet is ready to be installed with fast and easy electrical connectors and standard size hose fittings, for clean water inlet and waste water outlet. You will always receive the 3 components with several options and possibilities:



- A** **China toilet complete** of seat and cover and integrated **macerator pump** for waste pump out. *More information on pages 28 - 55.*



- B** **Control panel** / user interface.
More information on pages 66 - 68.



- C** **Clean water inlet device** / solenoid or inlet pump (dedicated).
More information on page 17.

See technical specifications on pages 18 - 19.

THE PROVEN TECHNOLOGY

Macerator

- Easier waste transfer and no clogging as the cutting blades emulsify all waste.
- Macerator chamber before the impeller for optimal grinding.
- Silent in operation.
- Integrated in the ceramic toilet.



Clean water inlet device

Depending on the installation on board this will be a solenoid valve or a central dedicated pressure pump to control either fresh or raw water flow.



Waste water flow

- Special discharge hose shape and two “one-way valves” are strategically positioned.
- Flexible discharge pipe installation with straight and elbow fittings.
- Locking and preventing backflow.
- Water traps of clean water.
- No bad smells.
- No cavitation.



Flush technology

- Efficient spray nozzle maximizes hygiene.
- Eliminates dripping rim.
- High-pressure water jet.
- Faster and better cleaning.
- 100% bowl coverage.
- Low water consumption per flush.



See technical specifications on pages 18 - 19.

TECHNICAL SPECIFICATIONS

Design line  & Flexi line 

	WIRE GAUGE SIZE CHART	
	Distance from source* is:	
	1-2 m	> 2 m
12V dc	11 AWG (4.17 mm ²)	9 AWG (6.63 mm ²)
24V dc	13 AWG (2.63 mm ²)	11 AWG (4.17 mm ²)
110-125V ac 60Hz	18 AWG (0.82 mm ²)	18 AWG (0.82 mm ²)
220-240V ac 50Hz or 60Hz	18 AWG (0.82 mm ²)	18 AWG (0.82 mm ²)

*Distance measured assumed power and ground wires

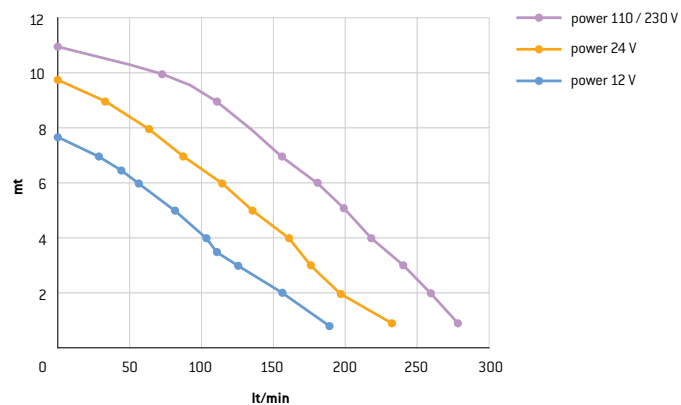

	MAC 11 outlet pump macerator turbine			
	12V dc	24V dc	110-125V ac 60Hz	220-240V ac 50Hz or 60Hz
Fuse recommended	40 A	30 A	8 A	5 A
Pump performance	Max 270 l/min 71.3 gm Max vertical head 11 mt 36.1 ft Max horizontal distance 90 mt 295.3 ft			
Outlet Duck Bill valve (male)	1 1/2" / required ID 1 1/2" (38.5mm)			

	INLET PUMP single system (raw water)	
	12V dc	24V dc
Fuse	8 A	4 A
Pressure	45 PSI - 3 bar	
Water flow	12 L/min 3.17 gmp	
Toilet inlet hose fitting (barbed)	1/2"	

	INLET SOLENOID centralized system			
	12V dc	24V dc	110-125V ac 60Hz	220-240V ac 50Hz or 60Hz
Power	9.5W	10W	6W	6W
Maximum pressure recommended	3 bar	3 bar	3 bar	3 bar
Solenoid inlet & outlet (threaded female)	1/2"			
Toilet inlet hose fitting (barbed)	1/2"			

Compact line

20-50 ft

	Distance from source* is:		
	0-6 mt { 0-20 ft }	6-10 mt { 30-32 ft }	10-15 mt { 33-50 ft }
12V dc	10 AWG (4.17 mm ²)	8 AWG (6.63 mm ²)	6 AWG (4.17 mm ²)
24V dc	16 AWG (2.63 mm ²)	14 AWG (4.17 mm ²)	12 AWG (2.63 mm ²)

*Distance measured assumed power and ground wires



MAC 4 outlet pump macerator turbine	12V dc	24V dc
Fuse recommended	30 A	20 A
Pump performance	Max vertical head 4 mt 13.1 ft Max horizontal distance 40 mt 131.2 ft	
Outlet Duck Bill valve (male)	1.5" / required ID 1.5" (38.5mm)	

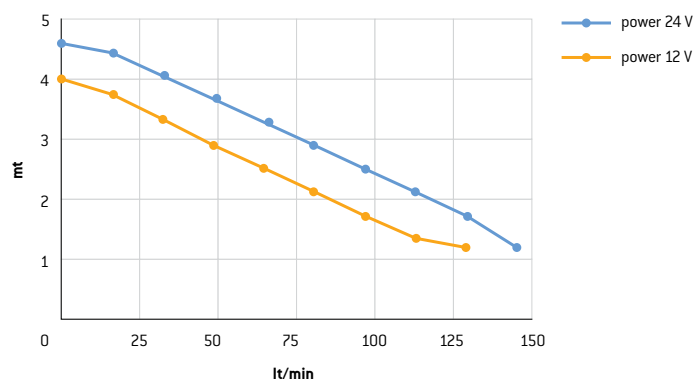

INLET SOLENOID centralized system	12V dc	24V dc
Power	9.5W	10W
Maximum pressure recommended	3 bar	3 bar
Solenoid inlet (threaded male)	1/2" / required female threaded 1/2"	
Solenoid outlet (barbed male)	1/4"	



INLET PUMP single system raw water system	12V dc	24V dc
Fuse	8 A	4 A
Pressure	45 PSI - 3 bar	
Water flow	12 l/min 3.17 gmp	
Toilet inlet hose fitting (barbed)	1/2"	

ALWAYS THE PERFECT FIT

> 100 ft



design line

This product line is recommended for yachts of 100 feet of length and more.

Modern furniture, decor, art, style and marine technology are all combined in this range of products. Pairing units in a bathroom offers attractive symmetry. Design creates values, values creates the future.

More information on page 26 - 37.

50-100 ft



flexi line 2G

This product line is recommended for yachts of length ranging between 50 and 100 feet.

When it gets to sanitation, Thetford Marine helps the designer to make this process as smooth and easy as possible. Thetford Marine developed perfect toilet designs in different sizes. The designer can pick up exactly what is required to outfit the specific bathroom, whether it is the master, VIP, guest, day or crew head.

More information on page 38 - 47.

> 100 ft



design line





	X-Light	X-Light Short	Privilege	Evolution
				
More information	page 28 - 29	page 28 - 29	page 30 - 31	page 32 - 33
H x W x D	430 x 360 x 470 mm 16.9 x 14.2 x 18.5 inches	330 x 360 x 470 mm 12.9 x 14.2 x 18.5 inches	485 x 390 x 500 mm 19.1 x 15.4 x 19.7 inches	445 x 370 x 555 mm 17.5 x 14.6 x 21.9 inches
Weight	7 kg / 15.4 lb	6.6 kg / 14.6 lb	28 kg / 61.7 lb	27 kg / 59.5 lb
Water usages per flush	0.5 - 2.7 L / 0.1 - 0.7 gal	0.5 - 2.7 L / 0.1 - 0.7 gal	0.5 - 2.7 L / 0.1 - 0.7 gal	0.5 - 2.7 L / 0.1 - 0.7 gal
Color	High gloss, clear coated carbon fiber construction [bowl inside white] Custom color on request	High gloss, clear coated carbon fiber construction [bowl inside white] Custom color on request	White	White
Seat and cover	High gloss, clear coated carbon fiber construction Custom color and color combinations available on request	High gloss, clear coated carbon fiber construction Custom color and color combinations available on request	Thermosetting with soft closing system (Sugatsune™ damper)	Thermosetting with soft closing system (Sugatsune™ damper)
Outlet pump (see page 18 - 19)	MAC 11 12/24 v	MAC 11 12/24 v	MAC 11 12/24 v	MAC 11 12/24 v
Inlet device* (see page 18 - 19)	Solenoid* Optional: inlet pump	Solenoid* Optional: inlet pump	Solenoid* Optional: inlet pump	Solenoid* Optional: inlet pump
Control panel (see page 71)	All-in-one SFT; Multiframe SFT; Touch SFT Multifunction	All-in-one SFT; Multiframe SFT; Touch SFT Multifunction	All-in-one SFT; Multiframe SFT; Touch SFT Multifunction	All-in-one SFT; Multiframe SFT; Touch SFT Multifunction
Accessories	page 73	page 73	page 73	page 73

*For raw water installations, we advise you to include a separate Thetford inlet pump.
Specifications subject to change.

50-100 ft



flexi line 2G

	E-Breeze	Silence Plus 2G	Silence Plus Short 2G	Silence 2G	Silence 2G Short
					
More information	page 34 - 37	page 44 - 45	page 44 - 45	page 46 - 47	page 46 - 47
H x W x D	550 x 390 x 500 mm 21.7 x 15.4 x 19.7 inches	460 x 390 x 510 mm 18.1 x 15.4 x 20.1 inches	350 x 390 x 510 mm 13.8 x 15.4 x 20.1 inches	460 x 370 x 430 mm 18.1 x 14.6 x 16.9 inches	360 x 370 x 430 mm 14.2 x 14.6 x 16.9 inches
Weight	30 kg / 66.1 lb	25.5 kg / 60.8 lb	23.5 kg / 51.8 lb	22.5 kg / 49.6 lb	19.5 kg / 42.9 lb
Water usages per flush	0.5 - 2.7 L / 0.1 - 0.7 gal	0.5 - 2.7 L / 0.1 - 0.7 gal	0.5 - 2.7 L / 0.1 - 0.7 gal	0.5 - 2.7 L / 0.1 - 0.7 gal	0.5 - 2.7 L / 0.1 - 0.7 gal
Color	White	White Optional: bone/black	White Optional: bone	White Optional: bone	White Optional: bone
Seat and cover	Multifunction seat and cover with integrated bidet Thermosetting with soft closing	Polyester with soft closing system {Sugatsune™ damper}	Polyester with soft closing system {Sugatsune™ damper}	Polyester with soft closing system {Sugatsune™ damper}	Polyester with soft closing system {Sugatsune™ damper}
Outlet pump (see page 18 - 19)	MAC 11 12/24 v	MAC 11 12/24 v	MAC 11 12/24 v	MAC 11 12/24 v	MAC 11 12/24 v
Inlet device (see page 18 - 19)	Solenoid* Optional: inlet pump	Solenoid* Optional: inlet pump	Solenoid* Optional: inlet pump	Solenoid* Optional: inlet pump	Solenoid* Optional: inlet pump
Control panel (see page 71)	All-in-one SFT; Multiframe SFT; Touch SFT Multifunction	All-in-one SFT; Multiframe SFT; Touch SFT Multifunction	All-in-one SFT; Multiframe SFT; Touch SFT Multifunction	All-in-one SFT; Multiframe SFT; Touch SFT Multifunction	All-in-one SFT; Multiframe SFT; Touch SFT Multifunction
Accessories	page 73	page 73	page 73	page 73	page 73

*For raw water installations, we advise you to include a separate Thetford inlet pump.

20-50 ft



compact line

Nano	Compass	Compass Short	Easy Fit	Easy Fit Short
				

More information	page 50 - 51	page 52 - 53	page 52 - 53	page 54 - 55	page 54 - 55
H x W x D	295 x 370 x 446 mm 11.6 x 14.6 x 17.5 inches		365 x 365 x 485 mm 14.4 x 14.4 x 19.1 inches	445 x 365 x 475 mm 17.5 x 14.4 x 18.7 in	365 x 365 x 475 mm 14.4 x 14.4 x 18.7 in
Weight	12.6 kg / 38.8 lb	21.5 kg / 47.4 lb	19.5 kg / 40.0 lb	21 kg / 47.4 lb	19.5 kg / 43.0 lb
Water usages per flush	0.5 - 2 L / 0.1 - 0.5 gal	0.5 - 2 L / 0.1 - 0.5 gal	0.5 - 2 L / 0.1 - 0.5 gal	0.5 - 2 L / 0.1 - 0.5 gal	0.5 - 2 L / 0.1 - 0.5 gal
Color	White	White	White	White Optional: bone	White Optional: bone
Seat and cover	Thermosetting	Thermosetting soft closing	Thermosetting soft closing	Wood with multicoat enamel finish	Wood with multicoat enamel finish
Outlet pump (see page 18 - 19)	MAC 4 12/24 v	MAC 4 12/24 v	MAC 4 12/24 v	MAC 4 12/24 v	MAC 4 12/24 v
Inlet device (see page 18 - 19)	Solenoid or Inlet pump	Solenoid or Inlet pump	Solenoid or Inlet pump	Solenoid or Inlet pump	Solenoid or Inlet pump
Control panel (see page 71)	Eco rocker or Premium Plus	Eco rocker or Premium Plus	Eco rocker or Premium Plus	Eco rocker or Premium Plus	Eco rocker or Premium Plus
Accessories	page 73	page 73	page 73	page 73	page 73

< 30 ft



portable line



More information	page 62 - 63	page 63	page 63	page 63
H x W x D	448 x 388 x 450 mm 17.6 X 15.3 X 17.7 in	313 x 342 x 382 mm 12.3 x 13.5 x 15 in	330 x 383 x 427 mm 13.0 x 15.1 x 16.8 in	414 x 383 x 427 mm 16.3 x 15.1 x 16.8 in
Weight	5.0 kg / 11 lb [Electric flush]	3.3 kg / 7.3 lb [Bellow / Piston flush]	3.8 kg / 8.4 lb [Piston flush]	4.0 kg / 8.8 lb [Piston flush]
Water usages per flush	N/A	N/A	N/A	N/A
Color	White	White	White	White
Seat and cover	Portable toilet seating height 443 mm / 17.4 inches	Portable toilet seating height 308 mm / 12.1 inches	Portable toilet seating height 324 mm / 12.8 inches	Portable toilet seating height 408 mm / 16.1 inches
Outlet pump	N/A	Optional: MSD model with plumbing adaptor for permanent pump	N/A	Optional: MSD model with plumbing adaptor for permanent pump
Inlet device	N/A	N/A	N/A	N/A
Control panel	N/A	N/A	N/A	N/A
Accessories	N/A	N/A	N/A	N/A

20-50 ft



compact line

This product line is recommended for yachts of length ranging between 20 and 50 feet.

It is a real challenge for a yacht designer to assemble all the components in the volume space of a 40 foot yacht, as boat owners expect to find the same level of comfort of a bigger yacht. These Tecma toilets are equipped with a properly sized macerator pump combined with a space saving toilet shape.

< 30 ft



portable line

This product line is recommended for yachts under 30 feet in length.

Dayboat and sport boats do not require a permanent sanitation system. Thetford Marine offers the perfect solution for fast, easy and cost effective sanitary solution. The affirmed quality of Thetford Porta Potti is the perfect compromise.





design line

> 100 ft



X-light

Privilege

Evolution

E-breeze

See component details on pages 66 - 69 and technical specifications on pages 18.

X-LIGHT

Extreme design, grand-prix performance



Full carbon fibre



Proven powerful macerator



X-Light

The X-Light range is the original Tecma full carbon fiber range of the toilet in high and low profile and the bidet. With this range Tecma offers pairing units for a luxury bathroom, but also a low profile X-Light Short to be facilitate installation on a step. The carbon fiber X-Light toilet has a weight of only 2 kg. So, extremely light, but also very strong. Equipped with the proven macerator and hoses the weight of the X-Light toilet is still only 7 kg.

A great combination of high quality, ultra-tech material and appealing modern looks.

The marine toilet is specially designed for high performance sailing and motor yachts.

The weight of the bowl is about 4.4 lb/2 kg, which with the other components, produces a toilet of less than 15.4 lb/7 kg in weight, some 41.8 lb/19 kg lighter than most traditional models. The innovative and easily accessible macerator pump is integrated. Design and production have been exposed to the full rigours of modern thinking.

Also on board: Wally, Baltic Yachts, Nautor Swan.

X-Light toilet

X-Light short



WEIGHT	X-Light & X-Light S: 7 kg / 15.4 lb X-Light Short: 6.6 kg / 14.6 lb
WATER USAGE	0.5 - 2.7 L / 0.1 - 0.7 gal per flush
COLOR	High gloss, clear coated carbon fiber construction (inside bowl white), Custom color on request
SEAT AND COVER	High gloss, clear coated carbon fiber construction, Custom color on request
OUTLET PUMP	MAC 11 12/24 v, p. 18
INLET DEVICE	Solenoid, optional: inlet pump
CONTROL PANEL	All-in-one SFT; Multifram SFT; Touch SFT Multifunction, p. 71
FEATURE	Ultra design, full carbon fibre, silent flush, low consumption
RELATED	Accessories, p. 73

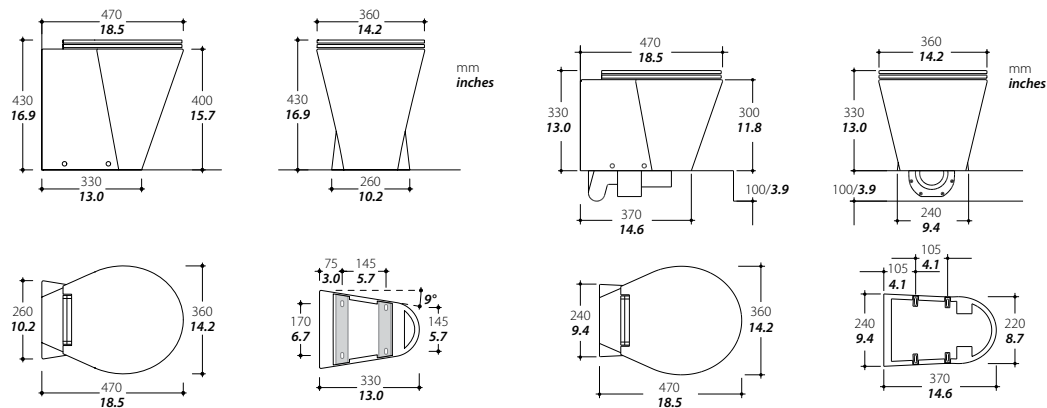

PRIVILEGE



Generous in size and comfort



Italian ceramic



Soft closing



Privilege

The Privilege collection is an original Tecma design.

Generous in size and extremely comfortable, the Privilege perfectly fits the contemporary trends in the domestic sanitation market. Its design reflects the high standards and more rounded forms of homestyle toilets.

The Privilege's rounded and ergonomically designed bowl gives this marine toilet a very original and distinctive designer look. This collection can be finished in a wide range of different colors and gloss or matte finishes. Tecma developed a special technology to laminate real gold or platinum on the outer surface for the most demanding customers.

Also on board: Majesty Yachts/ Azimut/ Gulfcraft/ NCA/ Sunreef.

Award: Dame 2008 / category winner.

Privilege toilet



WEIGHT	28 kg / 61.7 lb
WATER USAGE	0.5 - 2.7 L / 0.1 - 0.7 gal per flush
COLOR	White
SEAT AND COVER	Thermosetting with soft closing system (Sugatsune™ damper)
OUTLET PUMP	MAC 11 12/24 v, p. 18
INLET DEVICE	Solenoid, optional: inlet pump
CONTROL PANEL	All-in-one SFT; Multifram SFT; Touch SFT Multifunction, p. 71
FEATURE	Italian ceramic, ultra design, silent flush, low consumption
RELATED	Accessories, p. 73

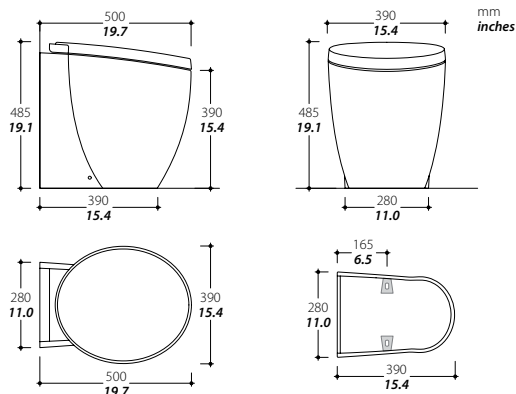

EVOLUTION



Advanced 'wall hung' solution



Italian ceramic



Soft closing



Evolution

A new design of the wall-mounted Evolution toilet with the same proven concept as the Tecma Evolution. The ceramics have an updated sleek design. The new Evolution is equipped with the 2G improved System which means an optimized hose system. A safe air admittance valve is integrated to prevent syphoning, backflows and installation constraints. The wall-mounted toilet not only gives a spacious and luxury look to the bathroom, it also saves floor space and offers maximum hygiene.

The soft closing seat and cover and the silent macerator make the Evolution the perfect combination to have on board.

Also on board: Acico Yacht/ Linssen Yacht/ Royal Huisman /Gulf Craft.

Award: Dame 2010 / nominated.

Evolution toilet



WEIGHT	27 kg / 59.5 lb
WATER USAGE	0.5 - 2.7 L / 0.1 - 0.7 gal per flush
COLOR	White
SEAT AND COVER	Thermosetting with soft closing system [Sugatsune™ damper]
OUTLET PUMP	MAC 11 12/24 v, p. 18
INLET DEVICE	Solenoid, optional: inlet pump
CONTROL PANEL	All-in-one SFT; Multiframe SFT; Touch SFT Multifunction, p. 71
FEATURE	Italian ceramic, suspended, silent flush, low consumption
RELATED	Accessories, p. 73

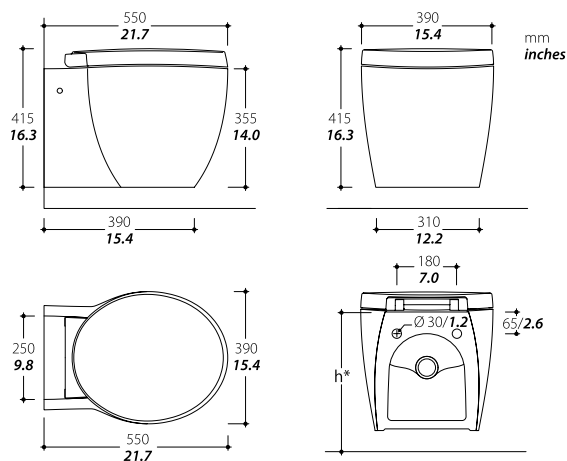

* Recommended height 430/450 mm/16.9/17.7 inches

E-BREEZE

Style and technology combined



Italian ceramic



Integrated electronic bidet



Soft closing



TECMA design line > 100 ft

E-Breeze

Designed to meet the requirements of international sanitary design and hygienic needs, the E-Breeze combines the proven reliability of Tecma marine toilet systems, with the innovative technology of the electronic multifunction bidet.

The installation is easy and is ideal also for interiors, where there is no space for a separated bidet or where weight saving is required.

A full set of certifications guarantees the quality of this new product: CQC, CE, IC, IEC, IECEE.

Electronic bidet features:

- Posterior, feminine and 'kids' cleaning program.
- Massage function.
- Heated seat with variable temperature setting.
- Warm water with variable temperature setting.
- Dryer.
- Deodorized.
- Function IIP (Intensive Impulse Pulsation). Variable spray.
- Automatic cleansing of the wands.

Also on board: San Lorenzo / Monte Carlo Yachts / Azimut / Dominator / Hatteras.

More about the E-Breeze on the next page.

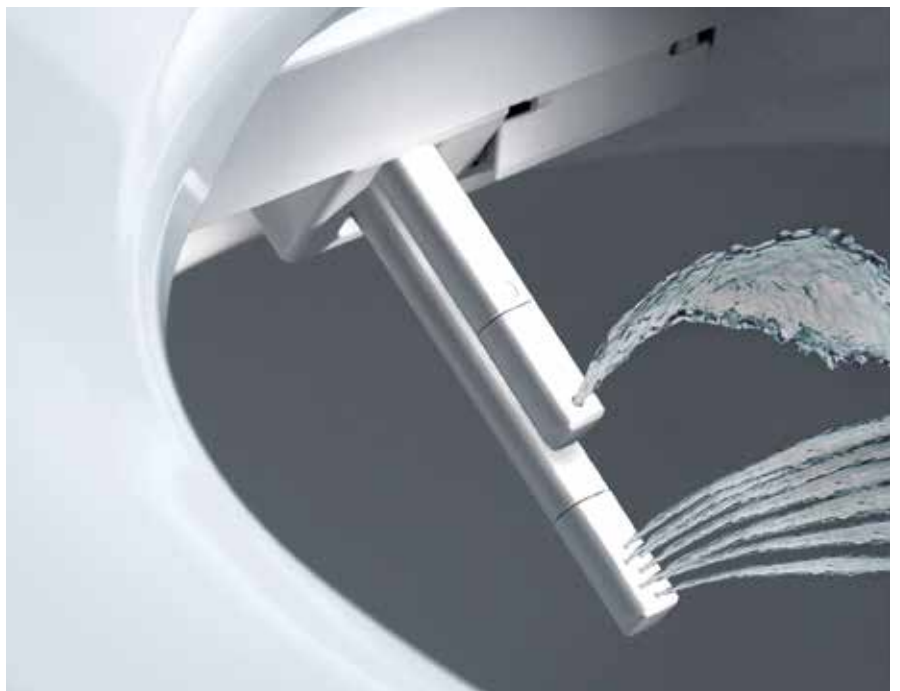

E-Breeze toilet



WEIGHT	30 kg / 66.1 lb
WATER USAGE	0.5 - 2.7 L / 0.1 - 0.7 gal per flush
COLOR	White
SEAT AND COVER	Multifunction seat and cover with integrated bidet, Thermosetting with soft closing system (Sugatsune™ damper)
INLET DEVICE	Solenoid, optional: inlet pump
CONTROL PANEL	All-in-one SFT; Multiframe SFT; Touch SFT Multifunction, p. 71
BIDET	Electronic integrated bidet
FEATURE	Italian ceramic, smooth design, silent flush, low consumption

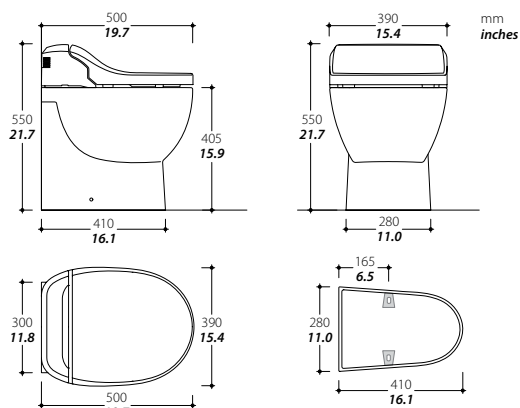

Electronic bidet technical details

Personalized controls		Wireless Remote Control - Batteries (AAA x 3)
Power supply		AC 220 ~ 240 V 50/60 Hz
Maximum power consumption		1160 - 1380 W
Tap water pressure		0.79 - 7.40 Atm
Heated seat	Temperature	Adjustable (3 levels) / 34 °C - 40 °C / 93.2 °F - 104.0 °F
	Safety device	Temp. fuse
	Power consumption	55 - 65 W
Hygiene	Temperature	Adjustable (3 levels) / 34 °C - 40 °C / 93.2 °F - 104.0 °F
	Water spray	Adjustable (5 levels) – max 1 L/min 0.2642 gpm
	Safety devices	Temp. fuse Thermal switch Floating switch
	Power consumption	1100 - 1309 W
Air dryer	Temperature	Adjustable (5 levels)
	Safety device	Temp. fuse
	Power consumption	280 - 333 W
Electricity safety protection		15 mA - GFCI
Power cord length (mm) inches		1800 mm / 70.9 inches
N° of wands		2
Degree of Protection		IP 24
Warranty		1 year

Electronic bidet and components

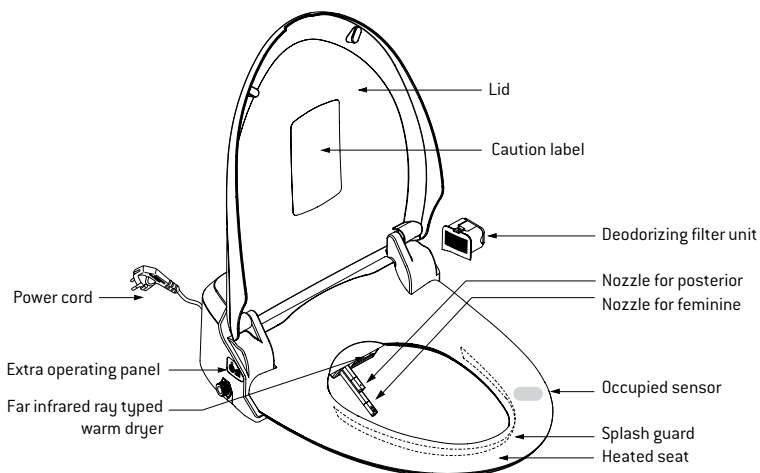
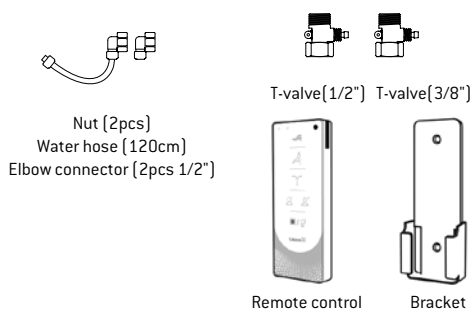

E-Breeze remote control

The multifunction electronic bidet is activated by an elegant wireless remote control. This is a pure combination of hygiene and technology in a heavy duty and fully certified marine solution.

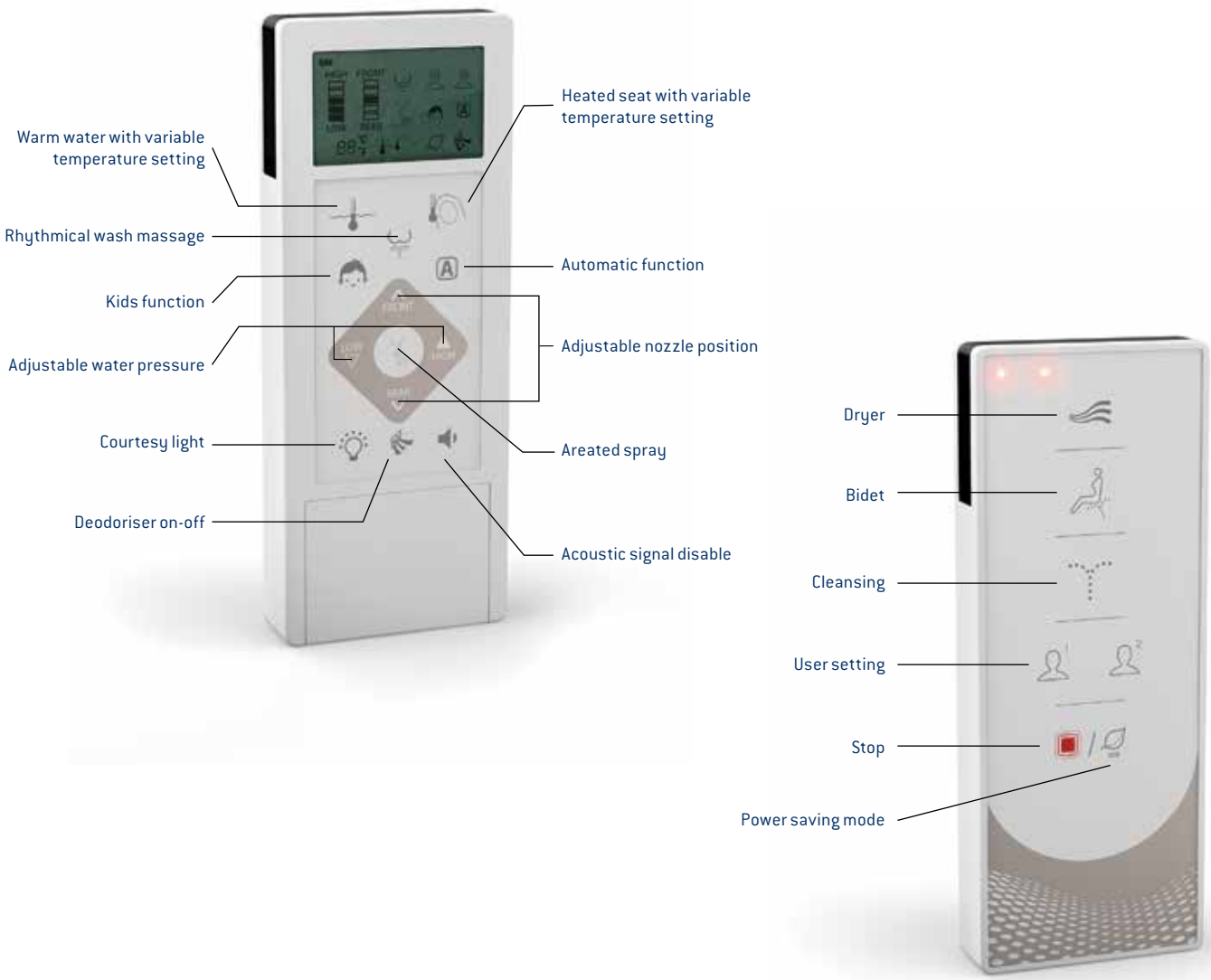

Airdryer



Catch plate



Deodorizer



Occupied sensor



Night light







flexi line 2G

50-100 ft



Flexi line 2G

Silence Plus 2G

Silence Plus 2G Short

Silence 2G

Silence 2G Short

See component details on pages 66 - 69 and technical specifications on pages 18.

FLEXI LINE 2G

CLEVER BEAUTY FOR SANITARY STYLE

the next generation



TECMA flexi line 50/100 ft

Flexi line toilets fit every bathroom

One of the strengths of the current Flexi Line is the flexibility to maintain the same design in every bathroom. With the new Flexi 2G Tecma moves a step ahead with a new toilet design. The Silence Plus 2G is the foundation for the Flexi Line. The same design is available in different sizes to match every bathroom.

Big, small, or short, 2nd generation Flexi Line toilets always fit.

Silence Plus 2G

Silence Plus 2G Short

Silence 2G

Silence 2G Short



The trusted Tecma quality with a new addition!

With over 100,000 Tecma macerator toilets onboard worldwide, you can rely on the SAME:

- Proven quality of current Tecma Flexi line toilets: Silence Plus and Silence
- Footprint
- Exterior dimensions
- Strong macerator technology
- Same control panel
- Same seat and cover
- 2-year warranty

Silence Plus



Next Generation
Silence Plus 2G



CLEVER IMPROVEMENTS ON INSTALLATION AND HYDRAULICS

Silence Plus 2G Short



Silence 2G Short



Short version through floor installation

Some applications require a short version of toilet and bidet with an adjusted height to be installed on a step.

Without compromises on performance and quality, all Tecma components have been further optimized to make the most of the available internal space.

An installation of a short toilet through the floor requires an additional cut out of the floor to accommodate protruding motor and hoses.

Silence Plus 2G Short



Cross section
Silence Plus 2G Short, Deep Bowl
(Through Floor Installation)

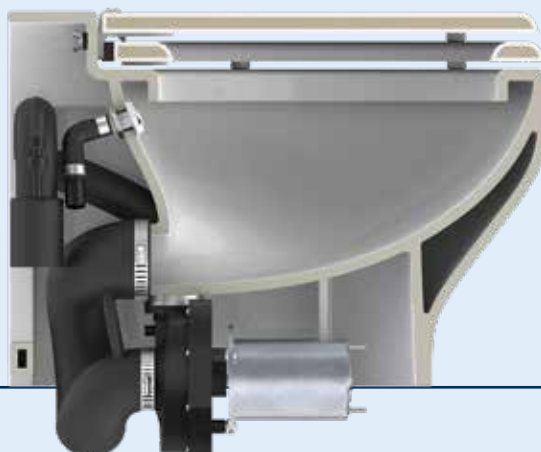

Floorplate

Quick and hidden installation

The different installation brings a great step forward in design and is really easy and fast to fix.

- Hidden installation enhances elegant design
- Side fixing fitting set allows installation in just a few steps
- Smooth surface makes cleaning easier



Integrated air admittance valve

Every single detail makes a difference. It's a small but essential and valuable valve and makes the difference for the new Flexi Line.

- Embedded in the internal hose system
- Prevents system installation constraints
- Optimizes venting on the discharge line
- Improves installation for a better black water system efficiency across different layouts
- Facilitates good hydraulics preventing syphoning and backflows
- Prevents service issues in the field



SILENCE PLUS 2G

Great design with the comfortable 'big bowl'



Italian ceramic



Proven powerful macerator



Low water and electricity consumption



Big bowl



Quiet and fast flush cycle



Low maintenance with no need to replace valves or seals



Silence Plus 2G

The 'big bowl' model of the Flexi-Line, the Silence Plus 2G forms the foundation for the Flexi Line. With the same features, a new design and new 2nd Generation System Improvements, it is supremely comfortable and effective. A length of 51 cm / **20.1 inches** creates an at-home seating feeling.

The model's short version is designed for installed on a raised step, usually 10 cm / **3.9 inches** high. For this purpose, the ceramic shell height is reduced to 36 cm / **14.2 inches** to compensate and match the standard seating height of 46 cm / **18.1 inches**.

Also on board: Azimut / San Lorenzo / Del Pardo / Hatteras / HCB / Nordhavn / Marlow / Sabre / Scout / Westport / Chris Craft / Weaver.

Silence Plus 2G



WEIGHT 25.5 kg / **56.2 lb**
H x W x D 460 x 390 x 510 mm /
18.1 x 15.4 x 20.1 inches

FOOTPRINT 405 x 280 mm / **15.9 x 11.1 inches**
WATER USAGE 0.5 - 2.7 L / **0.1 - 0.7 gal** per flush
COLOR White, optional: bone/black
SEAT AND COVER Polyester with soft closing system (Sugatsune™ damper)
OUTLET PUMP* MAC 11 12/24 v, p. 18
INLET DEVICE Solenoid, optional: inlet pump
CONTROL PANEL All-in-one SFT; Multiframe SFT; Touch SFT Multifunction, p. 71

Silence Plus 2G Short



WEIGHT 23.5 kg / **51.8 lb**
H x W x D 360 x 390 x 510 mm /
13.8 x 15.4 x 20.1 inches

FOOTPRINT 405 x 280 mm / **15.9 x 11.1 inches**
WATER USAGE 0.5 - 2.7 L / **0.1 - 0.7 gal** per flush
COLOR White, optional: bone
SEAT AND COVER Polyester with soft closing system (Sugatsune™ damper)
OUTLET PUMP* MAC 11 12/24 v, p. 18
INLET DEVICE Solenoid, optional: inlet pump
CONTROL PANEL All-in-one SFT; Multiframe SFT; Touch SFT Multifunction, p. 71

**2G 110V configurations are potentially available on request. Please consult our sales representatives.*

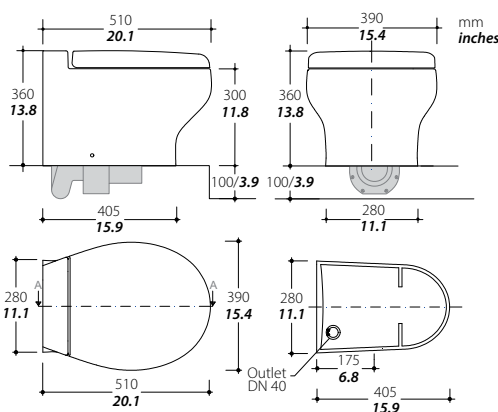
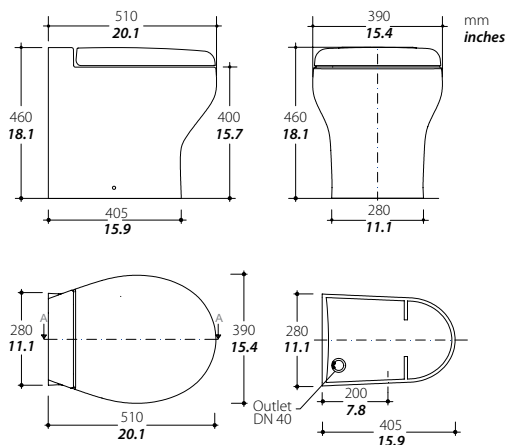

SILENCE 2G

Maximize the comfort within reduced space



Italian ceramic



Proven powerful macerator



Low water and electricity consumption



Medium bowl



Quiet and fast flush cycle



Low maintenance with no need to replace valves or seals



Silence 2G

As with Silence Plus 2G, the Silence 2G offers the same smooth design and smart 2nd Generation System Improvements. It just differs in size. Silence 2G models are the 'medium bowl' size model of the Flexi Line – and all about maximizing comfort in reduced space. A length of 43 cm / **16.9 inches** creates the at-home seat feeling.

The Silence 2G Short is designed to be installed on a raised step, usually 10 cm / **3.9 inches** high. For this purpose, the ceramic shell height is reduced to 36 cm / **14.2 inches** to compensate and match the standard seating height of 46 cm / **18.1 inches**.

Also on board: San Lorenzo / CNB / Montecarlo Yachts / Bertram Yachts / F&S Yachts / Ocean Alexander / Chris Craft / Yellowfin.

Silence 2G



WEIGHT 22.5 kg / **49.6 lb**
H x W x D 460 x 370 x 430 mm /
18.1 x 14.6 x 16.9 inches

FOOTPRINT 390 x 280 mm / **15.4 x 11.1 inches**
WATER USAGE 0.5 - 2.7 L / **0.1 - 0.7 gal** per flush
COLOR White, optional: bone
SEAT AND COVER Polyester with soft closing system (Sugatsune™ damper)
OUTLET PUMP* MAC 11 12/24 v, p. 18
INLET DEVICE Solenoid, optional: inlet pump
CONTROL PANEL All-in-one SFT; Multiframe SFT; Touch SFT Multifunction, p. 71

Silence 2G Short



WEIGHT 19.5 kg / **42.9 lb**
H x W x D 360 x 370 x 430 mm /
14.2 x 14.6 x 16.9 inches

FOOTPRINT 390 x 280 mm / **15.4 x 11.1 inches**
WATER USAGE 0.5 - 2.7 L / **0.1 - 0.7 gal** per flush
COLOR White, optional: bone
SEAT AND COVER Polyester with soft closing system (Sugatsune™ damper)
OUTLET PUMP* MAC 11 12/24 v, p. 18
INLET DEVICE Solenoid, optional: inlet pump
CONTROL PANEL All-in-one SFT; Multiframe SFT; Touch SFT Multifunction, p. 71

**2G 110V configurations are potentially available on request.
Please consult our sales representatives.*

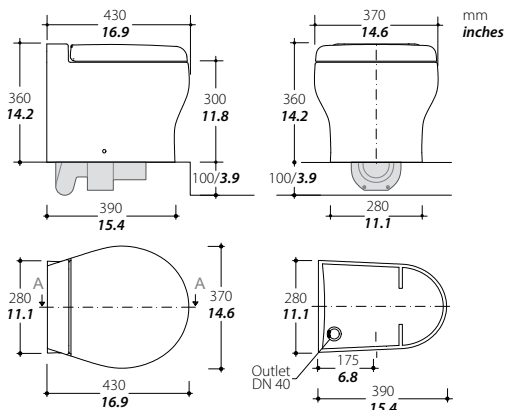
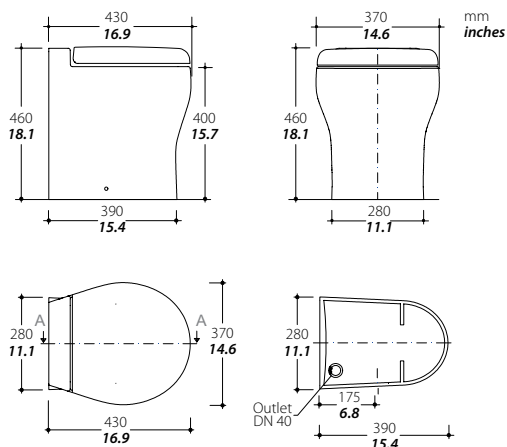





compact line

20-50 ft



Nano

Compass

Compass short

Easy Fit

Easy Fit short

See component details on pages 64-69 and technical specifications on pages 76-81.

NANO



Small in size, great in performance



Small footprint



Proven powerful macerator



Low water and electricity consumption



Self-contained and easy to install



Quiet and fast flush cycle



Low maintenance with no need to replace valves or seals



Nano

The Nano design combines a beautiful comfortable design with the smallest height in the market by still offering a reliable macerator toilet high performance. Especially designed to satisfy builders' stringent requirements, it's an innovative solution which Thetford Marine has created by embedding all technology in such a small space as 295 mm / **11.6 inches**. Silent as all Tecma toilets and particularly light due to his size, the Nano uses the consolidated ECO smart flush allowing to consume less water and power.

Extra low profile marine toilet:

- Quiet and fast flush cycle.
- Self contained and easy to install.
- No need of replacing seals or gaskets.
- Low water and electricity consumption.
- Super powerful macerator turbine technology.

Also on board: Chaparral Boats / Monterey / Edgewater / Fountain / Invincible / Back Cove / Regal / Solace / Sailfish.

Award: Dame 2014 / nominated.

Nano toilet



WEIGHT	17.6 kg / 38.8 lb
WATER USAGE	0.5 - 2 L / 0.1 - 0.5 gal per flush
COLOR	White
SEAT AND COVER	Thermosetting
OUTLET PUMP	MAC 4 12/24 v, p. 19
INLET DEVICE	Solenoid / inlet pump
CONTROL PANEL	Eco rocker / Premium Plus, p. 71
FEATURE	Italian ceramic, silent flush, low consumption, Only 295 mm / 11.6 inches

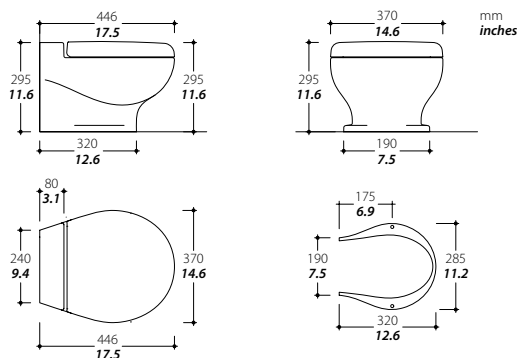

COMPASS

Maximum flexibility to fit everywhere



Only 295 mm / 11.6 inches



Proven powerful macerator



Low water and electricity consumption



Self-contained and easy to install



Quiet and fast flush cycle



Low maintenance with no need to replace valves or seals



Soft closing system



TECMA compact line 20-50 ft

Compass Short

The narrow footprint and smart back of the Compass toilet gives maximum space and maximum flexibility wherever it is installed on board. It can go straight to wall or even further towards the hull thanks to the cut away. The Compass is not limited by a vertical back. In this way the visual installation remains perfect, whatever installation space you have. The small footprint and the hose design facilitate a very easy installation. The discharge pipes can easily be connected either below the step or surface mounted in all directions. By having both a high and a short profile, the Compass range offers the maximum flexibility on board.

The performance of the macerator pump meets all quality standards, while the technology inside the toilet has been further developed to keep the sound emission to the lowest level possible, while limiting the water and electrical consumption to minimal levels. The installation, plumbing and wiring is easy and fast, with virtually no maintenance.

Both Compass High and Short version are equipped with an *innovative soft-closing system*. A gentle finger touch to the lid activates the soft-close damper mechanism, which controls the closing speed of the cover. In addition to user convenience, a slow-closing lid keeps noise to a minimum and prevents potential damage to the toilet seat. The soft-close damper mechanism is a design original to Tecma.

Also on board: Absolute / Cranchi / Galeon / Aviara / Bertram / Blackfin / Caymas / Sabre.

Compass



Soft closing system

WEIGHT	21.5 kg / 47.4 lb
WATER USAGE	0.5 - 2 L / 0.1 - 0.5 gal per flush
COLOR	White
SEAT AND COVER	Thermosetting with soft closing system
OUTLET PUMP	MAC 4 12/24 v, p. 19
INLET DEVICE	Solenoid / Inlet pump
CONTROL PANEL	Eco rocker / Premium Plus, p. 71
FEATURE	Italian ceramic, silent flush, low consumption.

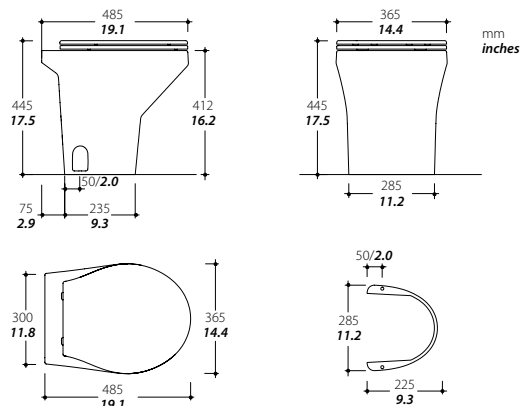

Compass Short



WEIGHT	19.5 kg / 43.0 lb
WATER USAGE	0.5 - 2 L / 0.1 - 0.5 gal per flush
COLOR	White
SEAT AND COVER	Thermosetting with soft closing system
OUTLET PUMP	MAC 4 12/24 v, p. 19
INLET DEVICE	Solenoid / Inlet pump
CONTROL PANEL	Eco rocker / Premium Plus, p. 71
FEATURE	Italian ceramic, silent flush, low consumption.

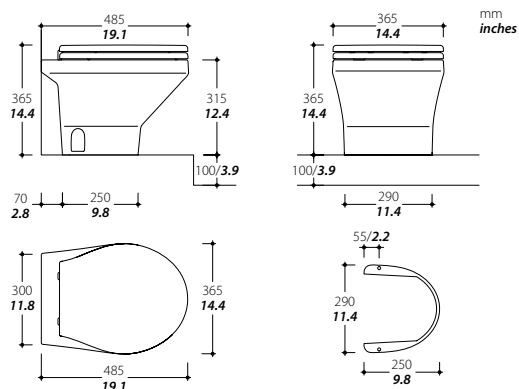

EASY FIT

Small compact and powerful



Small footprint



Proven powerful macerator



Low water and electricity consumption



Self-contained and easy to install



Quiet and fast flush cycle



Low maintenance with no need to replace valves or seals



Easy Fit

The Easy Fit is already found on board many small yachts and tenders. With a compact design, exquisite china exterior and electric flush, the Easy Fit models are powerful performers. Comfortable ceramic bowls, high output, low water consumption and silent flush are only a few of the many features of this model.

This model is available in two different sizes, namely the standard height model and the short height version for installations where mounted on top of a raised step. The special geometry of the back side, allows an easy installation against both straight and angled walls.

The installation, plumbing and wiring is easy and fast, with no maintenance required. The toilet can be operated in combination with two different control panels: Eco and Premium Plus.

Also on board: Azimut / Chaparral / Cigarette Racing / Jupiter / Marquis / Regal / Regulator / Sabre / Scout / Monterey / Sailfish.

Easy Fit toilet



WEIGHT	21.5 kg / 47.4 lb
WATER USAGE	0.5 - 2 L / 0.1 - 0.5 gal per flush
COLOR	White; optional: bone
SEAT AND COVER	Wood with multicoat enamel finish
OUTLET PUMP	MAC 4 12/24 v, p. 19
INLET DEVICE	Solenoid / Inlet pump
CONTROL PANEL	Eco rocker / Premium Plus, p. 71
FEATURE	Compact, silent flush, low consumption
RELATED	Accessories, p. 73

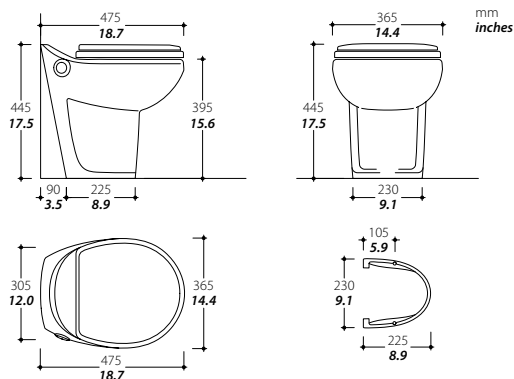

Easy Fit Short toilet



WEIGHT	19.5 kg / 43.0 lb
WATER USAGE	0.5 - 2 L / 0.1 - 0.5 gal per flush
COLOR	White; optional: bone
SEAT AND COVER	Wood with multicoat enamel finish
OUTLET PUMP	MAC 4 12/24 v, p. 19
INLET DEVICE	Solenoid / Inlet pump
CONTROL PANEL	Eco rocker / Premium Plus, p. 71
FEATURE	Compact, silent flush, low consumption
RELATED	Accessories, p. 73

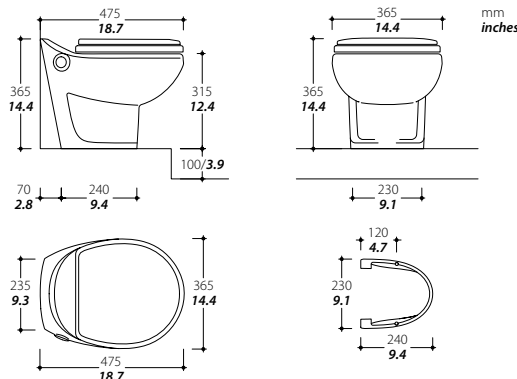

HOW TO ORDER

WHAT YOU NEED TO ORDER TO RECEIVE A FUNCTIONING TOILET

Design line  > 100 ft & Flexi line  50-100 ft

FRESH WATER

Toilet SKU



- Includes everything but the control panel

Control Panel SKU

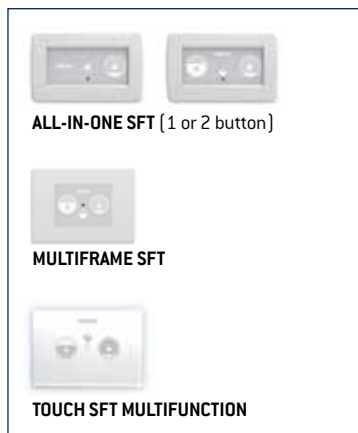

RAW WATER

For raw water, order inlet pump kit separately and disregard soleoid.





Eco Kit

TOILET SKU



COMPASS



EASYFIT



NANO



CONTROLLER



ECO KITS: SKUs

FRESH WATER



SOLENOID



ECO ROCKER SWITCH

ELECTRICAL
CONNECTOR
WIRE
HARNESS

RAW WATER

With Inlet Pump



INLET PUMP



ECO ROCKER SWITCH

ELECTRICAL
CONNECTOR
WIRE
HARNESS

FITTING

Without Inlet Pump



ECO ROCKER SWITCH

ELECTRICAL
CONNECTOR
WIRE
HARNESS

FITTING

- Controller included
- Panel switch not included (to be ordered with Eco Kit SKU)

Premium Plus Kit

TOILET SKU



COMPASS



EASYFIT



NANO



CONTROLLER



PREMIUM PLUS
CONTROL PANEL



PREMIUM PLUS KITS: SKUs

FRESH WATER



SOLENOID

WATER
FITTING

RAW WATER

Water Fitting with Inlet Pump



INLET PUMP

WATER
FITTING

Water Fitting without Inlet Pump

WATER
FITTING

- Controller and Panel switch included

MENU ORDERING SKUs

Design line  > 100 ft & Flexi line  50-100 ft

TOILETS			
	SKU	SHORT DESCRIPTION	EXTENDED DESCRIPTION
SILENCE 2G	98357	T-S2G-012-H-W-PSOF-S-00000-0-0	SILENCE 2G 12V, HIGH, WHITE, WITH WOOD POLYESTER SOFT CLOSE SEAT & STANDARD SOLENOID
	98356	T-S2G-012-D-W-PSOF-S-00000-0-0	SILENCE 2G 12V, SHORT, WHITE, WITH WOOD POLYESTER SOFT CLOSE SEAT & STANDARD SOLENOID
	98355	T-S2G-024-H-W-PSOF-S-00000-0-0	SILENCE 2G 24V, HIGH, WHITE, WITH WOOD POLYESTER SOFT CLOSE SEAT & STANDARD SOLENOID
	98354	T-S2G-024-D-W-PSOF-S-00000-0-0	SILENCE 2G 24V, SHORT, WHITE, WITH WOOD POLYESTER SOFT CLOSE SEAT & STANDARD SOLENOID
	98353	T-S2G-012-H-P-PSOF-S-00000-0-0	SILENCE 2G 12V, HIGH, BONE, WITH WOOD POLYESTER SOFT CLOSE SEAT & STANDARD SOLENOID
	98352	T-S2G-012-D-P-PSOF-S-00000-0-0	SILENCE 2G 12V, SHORT, BONE, WITH WOOD POLYESTER SOFT CLOSE SEAT & STANDARD SOLENOID
	98351	T-S2G-024-H-P-PSOF-S-00000-0-0	SILENCE 2G 24V, HIGH, BONE, WITH WOOD POLYESTER SOFT CLOSE SEAT & STANDARD SOLENOID
	98350	T-S2G-024-D-P-PSOF-S-00000-0-0	SILENCE 2G 24V, SHORT, BONE, WITH WOOD POLYESTER SOFT CLOSE SEAT & STANDARD SOLENOID
SILENCE 2G 110 v	98331	T-S2G-110-H-W-PSOF-S-00000-0-0	SILENCE 2G 110v, HIGH, WHITE, WITH POLYESTER SOFT CLOSE & STANDARD SOLENOID
SILENCE PLUS 2G	98349	T-S+2-012-H-W-PSOF-S-00000-0-0	SILENCE PLUS 2G 12V, HIGH, WHITE, WITH WOOD POLYESTER SOFT CLOSE SEAT & STANDARD SOLENOID
	98348	T-S+2-012-D-W-PSOF-S-00000-0-0	SILENCE PLUS 2G 12V, SHORT, WHITE, WITH WOOD POLYESTER SOFT CLOSE SEAT & STANDARD SOLENOID
	98347	T-S+2-024-H-W-PSOF-S-00000-0-0	SILENCE PLUS 2G 24V, HIGH, WHITE, WITH WOOD POLYESTER SOFT CLOSE SEAT & STANDARD SOLENOID
	98346	T-S+2-024-D-W-PSOF-S-00000-0-0	SILENCE PLUS 2G 24V, SHORT, WHITE, WITH WOOD POLYESTER SOFT CLOSE SEAT & STANDARD SOLENOID
	98345	T-S+2-012-H-P-PSOF-S-00000-0-0	SILENCE PLUS 2G 12V, HIGH, BONE, WITH WOOD POLYESTER SOFT CLOSE SEAT & STANDARD SOLENOID
	98344	T-S+2-012-D-P-PSOF-S-00000-0-0	SILENCE PLUS 2G 12V, SHORT, BONE, WITH WOOD POLYESTER SOFT CLOSE SEAT & STANDARD SOLENOID
	98343	T-S+2-024-H-P-PSOF-S-00000-0-0	SILENCE PLUS 2G 24V, HIGH, BONE, WITH WOOD POLYESTER SOFT CLOSE SEAT & STANDARD SOLENOID
	98342	T-S+2-024-D-P-PSOF-S-00000-0-0	SILENCE PLUS 2G 24V, SHORT, BONE, WITH WOOD POLYESTER SOFT CLOSE SEAT & STANDARD SOLENOID
	98333	T-S+2-012-H-B-PSOF-S-00000-0-0	SILENCE PLUS 2G 12V, HIGH, BLACK, WITH WOOD POLYESTER SOFT CLOSE SEAT & STANDARD SOLENOID
	98334	T-S+2-024-H-B-PSOF-S-00000-0-0	SILENCE PLUS 2G 24V, HIGH, BLACK, WITH WOOD POLYESTER SOFT CLOSE SEAT & STANDARD SOLENOID
SILENCE PLUS 2G 110 V	98341	T-S+2-110-H-W-PSOF-S-00000-0-0	SILENCE PLUS 2G 110V, HIGH, WHITE, WITH WOOD POLYESTER SOFT CLOSE SEAT & STANDARD SOLENOID
DESIGN LINE	98340	T-PRI-024-H-W-TSOF-S-00000-0-0	PRIVILEGE 24V, HIGH, WHITE, WITH THERMOSETTING SOFT CLOSE SEAT & STANDARD SOLENOID
	98339	T-EV2-024-H-W-TSOF-S-00000-0-0	EVOLUTION 24V, HIGH, WHITE, WITH THERMOSETTING SOFT CLOSE SEAT & STANDARD SOLENOID
	98338	T-BRU-012-H-W-TSOF-S-00000-0-0	EBREEZE 12V, HIGH, WHITE, WITH THERMOSETTING SOFT CLOSE ELECTRONIC COVER BIDET & STANDARD SOLENOID
	98337	T-BRU-024-H-W-TSOF-S-00000-0-0	EBREEZE 24V, HIGH, WHITE, WITH THERMOSETTING SOFT CLOSE ELECTRONIC COVER BIDET & STANDARD SOLENOID
	98336	T-XLI-024-H-B-TSTD-S-00000-0-0	X-LIGHT CARBON TOILET 24V, HIGH, CARBON CLEAR COATED, STANDARD CARBON COVER SEAT & STANDARD SOLENOID
	98335	T-XLI-024-S-B-TSTD-S-00000-0-0	X-LIGHT CARBON TOILET 24V, SHORT, CARBON CLEAR COATED, STANDARD CARBON COVER SEAT & STANDARD SOLENOID

CONTROL PANELS		
	SKU	DESCRIPTION
CONTROL PANELS	36082	STANDARD ALL IN ONE SFT 1B CONTROL PANEL
	38072B	STANDARD ALL IN ONE SFT 2B CONTROL PANEL
	98126B	MULTIFRAME SFT 2B CONTROL PANEL
	98122B	TOUCH GLASS SFT 2B CONTROL PANEL
	98131	CUSTOM MADE - ALL IN ONE SFT 2B CONTROL PANEL (DEUTSCH CONNECTORS)

OPTION (RAW WATER KIT)		
	SKU	DESCRIPTION
RAW WATER KITS	38147	MARINE WATER PUMP 24V
	38148	MARINE WATER PUMP 12V

Compact line

25-50 ft



TOILETS		
	SKU	DESCRIPTION
EASYFIT ECO	38485	EASYFIT ECO (HI) WHITE 12V (WITHOUT SOLENOID AND WITHOUT ROCKER SWITCH)
	38486	EASYFIT ECO (LO) WHITE 12V (WITHOUT SOLENOID AND WITHOUT ROCKER SWITCH)
	38489	EASYFIT ECO (HI) WHITE 24V (WITHOUT SOLENOID AND WITHOUT ROCKER SWITCH)
	38490	EASYFIT ECO (LO) WHITE 24V (WITHOUT SOLENOID AND WITHOUT ROCKER SWITCH)
	38487	EASYFIT ECO (HI) BONE 12V (WITHOUT SOLENOID AND WITHOUT ROCKER SWITCH)
	38488	EASYFIT ECO (LO) BONE 12V (WITHOUT SOLENOID AND WITHOUT ROCKER SWITCH)
	38491	EASYFIT ECO (HI) BONE 24V (WITHOUT SOLENOID AND WITHOUT ROCKER SWITCH)
	38492	EASYFIT ECO (LO) BONE 24V (WITHOUT SOLENOID AND WITHOUT ROCKER SWITCH)
EASYFIT PREMIUM PLUS	38830	EASYFIT PREMIUM PLUS (HI) WHITE 12V (WITHOUT SOLENOID)
	38832	EASYFIT PREMIUM PLUS (LO) WHITE 12V (WITHOUT SOLENOID)
	38831	EASYFIT PREMIUM PLUS (HI) WHITE 24V (WITHOUT SOLENOID)
	38833	EASYFIT PREMIUM PLUS (LO) WHITE 24V (WITHOUT SOLENOID)
	38834	EASYFIT PREMIUM PLUS (HI) BONE 12V (WITHOUT SOLENOID)
	38836	EASYFIT PREMIUM PLUS (LO) BONE 12V (WITHOUT SOLENOID)
	38835	EASYFIT PREMIUM PLUS (HI) BONE 24V (WITHOUT SOLENOID)
	38837	EASYFIT PREMIUM PLUS (LO) BONE 24V (WITHOUT SOLENOID)
NANO ECO	38983	NANO ECO WHITE 12 V (WITHOUT SOLENOID AND WITHOUT ROCKER SWITCH)
	38984	NANO ECO WHITE 24 V (WITHOUT SOLENOID AND WITHOUT ROCKER SWITCH)
	38995	NANO ECO WHITE 12 V DEUTSCH CONN. (WITHOUT SOLENOID AND WITHOUT ROCKER SWITCH)
	98096	NANO ECO WHITE 24 V DEUTSCH CONN. (WITHOUT SOLENOID AND WITHOUT ROCKER SWITCH)
NANO PREMIUM PLUS	38985	NANO PREM PLUS WHITE 12 V (WITHOUT SOLENOID)
	38986	NANO PREM PLUS WHITE 24 V (WITHOUT SOLENOID)
COMPASS ECO	38990	TECMA COMPASS ECO (LO) 12 V SOLENOID (WITHOUT SOLENOID AND WITHOUT ROCKER SWITCH)
	38991	TECMA COMPASS ECO (LO) 24 V SOLENOID (WITHOUT SOLENOID AND WITHOUT ROCKER SWITCH)
	98305	TECMA COMPASS ECO (HI) 12 V SOLENOID (WITHOUT SOLENOID AND WITHOUT ROCKER SWITCH)
	98307	TECMA COMPASS ECO (HI) 24 V SOLENOID (WITHOUT SOLENOID AND WITHOUT ROCKER SWITCH)
COMPASS PREMIUM PLUS	38992	TECMA COMPASS PREM PLUS (LO) 12 V (WITHOUT SOLENOID)
	38993	TECMA COMPASS PREM PLUS (LO) 24 V (WITHOUT SOLENOID)
	98306	TECMA COMPASS PREM PLUS (HI) 12 V (WITHOUT SOLENOID)
	98308	TECMA COMPASS PREM PLUS (HI) 24 V (WITHOUT SOLENOID)
ECO KITS		
	SKU	DESCRIPTION
ECO	38670	ECO SOLENOID, HARNESS & ACC PKG 12V
	38680	ECO SOLENOID, HARNESS & ACC PKG 24V
	38679	ECO RAW PUMP & HARNESS & ACC PKG 12V
	38682	ECO RAW PUMP & HARNESS & ACC PKG 24V
	38671	ECO RAW WATER FITTING + ELECTRICAL CONNECTOR + WIRE HARNESS AND SWITCH 12V (W/O WATER PUMP)
	38681	ECO RAW WATER FITTING + ELECTRICAL CONNECTOR + WIRE HARNESS AND SWITCH 24V (W/O WATER PUMP)
PREMIUM PLUS KITS		
	SKU	DESCRIPTION
PREMIUM PLUS	38862	RAW WATER PUMP & FITTING 12V
	38863	RAW WATER PUMP & FITTING 24V
	38859	SOLENOID FOR FRESH WATER COMPACT LINE (12V)
	38860	SOLENOID FOR FRESH WATER COMPACT LINE (24V)
	38861	RAW WATER FITTING + ELECTRICAL CONNECTOR (PREMIUM PLUS)





portable line

< 30 ft



Porta Potti 565E

Porta Potti 135/335

Porta Potti 345

Porta Potti 365

THETFORD PORTABLE SANITATION

Don't make sacrifices when you "hit the water"

That's why Thetford Marine Heads are designed to offer comfort, convenience and a worry-free trip. They're sanitary, odorless, leakproof and contain their own fresh water supply for flushing. Quality construction, compact design and ease of operation – Thetford Heads are designed and built to give years of trouble-free service. Made from light-weight, high-impact plastics, they are rugged, durable and reliable – functioning day-after-day, trip-after-trip.

Porta Potti®

Still the original...and the best!

Features

- Durable, easy to use and clean
- Contemporary styling with integrated seat and cover
- Ergonomic Carrying Handle
- Lid Latch
- Exclusive, rotating Pour-Out Spout
- Removable seat and cover for easy cleaning
- Sealed valve keeps odors in holding tank
- Optional Hold-Down Bracket:
 - For 345 model: SKU# 92921
 - For 365 model: SKU# 92922
- Easy-to-read Level Indicator tells when it's time to empty*
- Piston pump flush*

*except 135

To Prepare for use:

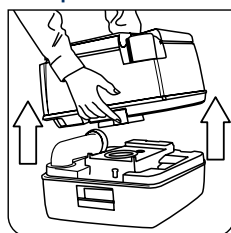

Separate the tanks

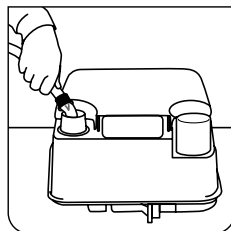

Fill the upper tank with tap water

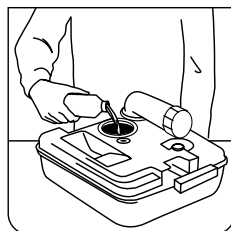

Add deodorant to the lower tank

To Empty:

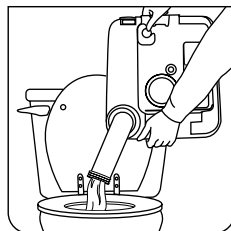

Rotate spout, remove cap, press air relief valve button and pour into toilet

565E Features

- Battery-powered flush
- Sleek, modern and homelike design
- Comfortable seat height
- Increased bowl size
- Hidden controls
- User-friendly Flush Lever
- Improved Water Tank Carrying Handle
- Optional Hold-Down Kit (SKU# 92415)
- Integrated Toilet Paper Holder
- Holding Tank Level Indicator for fresh water and waste tanks



565E



Porta Potti 565E awards:



THETFORD compact line <30 ft



Also available for MSD application with models



135



335



365

MSD versions require a dedicated discharge port and vent through hull. Instead of having the pour spout on the waste tank, this device allows you to fit a hose on the waste tank to be directly plumbed to a deck fitting for shore side discharge at a Pump Out Station without removing the Porta Potti.

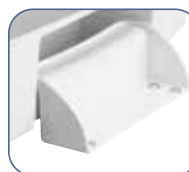

Optional
Hold-Down
Bracket

How to transform PP 135, 335 and 365 into a MSD

- For PP 135/335 purchase the short MSD fitting #40158 and replace the pour spout
- For 365 purchase the long MSD fitting #40157 and replace the pour spout



	MSD versions			
	Porta Potti 565E	Porta Potti 345	Porta Potti 135/335	Porta Potti 365
SKU / Model	92306 / 565E	92814 / 345	92860/135 Bellows 92861/135 Bellows Marine 92828/335 Piston Marine	92820 / 365
H x W x D	448 x 388 x 450 mm 17.6 X 15.3 X 17.7 in	330 x 383 x 427 mm 13.0 x 15.1 x 16.8 in	313 x 342 x 382 mm 12.3 x 13.5 x 15 in	414 x 383 x 427 mm 16.3 x 15.1 x 16.8 in
Seating height	443 mm 17.4 inches	338 mm 13.3 inches	308 mm 12.1 inches	417 mm 16.4 inches
Color	White	White	White	White
Flushing system	Electric	Piston	Bellow / Piston	Piston
Average flushes	56	33	27	56
Waste-holding tank level indicator	Yes	Yes	Yes (except 92860/135)	Yes
Waste-holding tank capacity	20.8 L / 5.5 gal	12.1 L / 3.2 gal	9.8 L / 2.6 gal	20.8 L / 5.5 gal
Flush-water tank level indicator	Yes	No	No	No
Flush-water tank capacity	15 L / 4.0 gal	15 L / 4.0 gal	10 L / 2.6 gal	15 L / 4.0 gal
Weight kg / lb	5.7 kg / 12.5 lb	4.5 kg / 10 lb	3.9 kg / 8.8 lb	4.8 kg / 10.5 lb
Hold-Down Kit	optional (92415)	optional (92921)	included (except 92860/135)	optional (92922)





holding tank care

Holding Tank Deodorants

AquaBio™

AquaMax®

Toilet Tissue

Aqua-Soft®

RV/Marine

THETFORD HOLDING TANK CARE

Holding Tank Deodorants

AquaBio™, a new twist on holding tank treatments.

Thetford has been developing Toilet Care products, which ensure proper functioning of our mobile toilets, for over 50 years. The research departments in the renowned company-owned laboratories and external institutes, constantly develop and test new products. To reduce the risk of damage, premature wear and problems when emptying the waste holding tank, it is recommended to use Thetford Toilet Care products.

The toilet additives prevent unpleasant smells, suppress gas formation and keep the inside of the waste holding tank clean.

AquaBio™ Liquid

- Quickly breaks down and liquefies waste and toilet
- Extended odor control
- Citrus Twist Scent

AquaBio™ Toss-Ins

- Quick-acting formula in a convenient package
- Water-soluble packets that easy to use: Simply toss 'em in the toilet and flush!

AquaBio™ Dry

- Waterproof packs with non-dusting granules
- Convenient package: tear open foil, empty content in toilet, and flush

Thetford's next generation of holding tank solutions complies with new California regulations. AquaBio™ offers today's boaters a Formaldehyde and Bronopal Free formula.

The quick-acting holding tank treatment eliminates odors while digesting waste and toilet paper to prevent clogging, all without any harsh chemicals.

AquaBio™ is formulated and tested safe for marine heads & toilets, holding tanks and septic systems.



NO FORMALDEHYDE • NO BRONOPOL

	Description	Qty per Carton	Carton Wt (lb)	Carton Vol (cf)
96590	AquaBio™ 16-Pack Toss-Ins®	12	15.0	0.56
96591	AquaBio™ 30-Pack Toss-Ins®	4	12.0	0.51
96600	AquaBio™ 8-Pack Dry Granules	12	14.4	0.54
96604	AquaBio™ 6-Pack – 8-oz. Liquid 6	6	24.4	0.92
96607	AquaBio™ 32-oz. Liquid	12	28.8	0.77
96610	AquaBio™ 64-oz. Liquid	6	29.2	0.84
96614	AquaBio™ 1-gallon Liquid	4	39.0	1.01

AquaMax®

AquaMax® Holding Tank Treatment's advanced-action Enzyme Powered Formula neutralizes odors and accelerates waste digestion to prevent clumping, clogging and tank residue, all at the same time.

- Advanced-Action
- Triple Enzyme Formula
- Beneficial Probiotics
- Maximum Odor Control
- Breaks Down Waste & Tissue
- Marina Friendly and Septic Safe



NO FORMALDEHYDE • NO BRONOPOL

	Spring Showers Scent	Qty per Carton	Carton Wt (lb)	Carton Vol (cf)
96631	AquaMax® 16-Pack Toss-Ins®	12	13.5	0.42
96632	AquaMax® 30-Pack Toss-Ins®	4	13.5	0.40
96633	AquaMax® 8-Pack Dry Granules	12	13.5	0.41
96634	AquaMax® 6-Pack – 8-oz. Liquid	6	17.5	0.49
96635	AquaMax® 32-oz. Liquid	12	3.5	0.54
96636	AquaMax® 64-oz. Liquid	6	7.5	0.34
96637	AquaMax® 1-gallon Liquid	4	13.0	0.51

	Summer Cypress Scent	Qty per Carton	Carton Wt (lb)	Carton Vol (cf)
96670	AquaMax® 16-Pack Toss-Ins®	12	13.5	0.42
96665	AquaMax® 30-Pack Toss-Ins®	4	13.5	0.40
96674	AquaMax® 8-Pack Dry Granules	12	13.5	0.41
96689	AquaMax® 6-Pack – 8-oz. Liquid	6	17.5	0.49
96686	AquaMax® 32-oz. Liquid	12	3.5	0.54
96682	AquaMax® 64-oz. Liquid	6	7.5	0.34
96678	AquaMax® 1-gallon Liquid	4	13.0	0.51

Holding Tank Cleaner

Tank Blaster™ Black & Grey Holding Tank Cleaner

- Super-concentrated enzymatic blend dissolves tissue and prevents build-up and messy clogs
- Micro-Foam™ action works overnight

	Description	Information	Qty	Carton Wt (lb)	Carton Vol (cf)
96527	Tank Blaster™ Holding Tank Cleaner	4 – 1.6-oz. treatments	6	2.8	0.29



Toilet Tissue

Aqua-Soft® Toilet Tissue

- Luxurious 2-ply tissue specially-made for Marine and RV sanitation systems
- Prevents clogging by rapidly dissolving in holding tanks
- Soft, snowy white and highly absorbent; 100% biodegradable

RV/Marine Toilet Tissue

- Economical 1-ply tissue specially-made for Marine and RV sanitation systems
- Prevents clogging by rapidly dissolving in holding tanks; 100% biodegradable



	Description	Information	Qty	Carton Wt (lb)	Carton Vol (cf)
03300	Aqua Soft Tissue	4-Pack - 396 Sheets Per Roll - 2 Ply	12	19.2	2.75
20804	RV/Marine Toilet Tissue	4-Pack - 350 Sheets Per Roll - 1-Ply	24	20.8	4.64

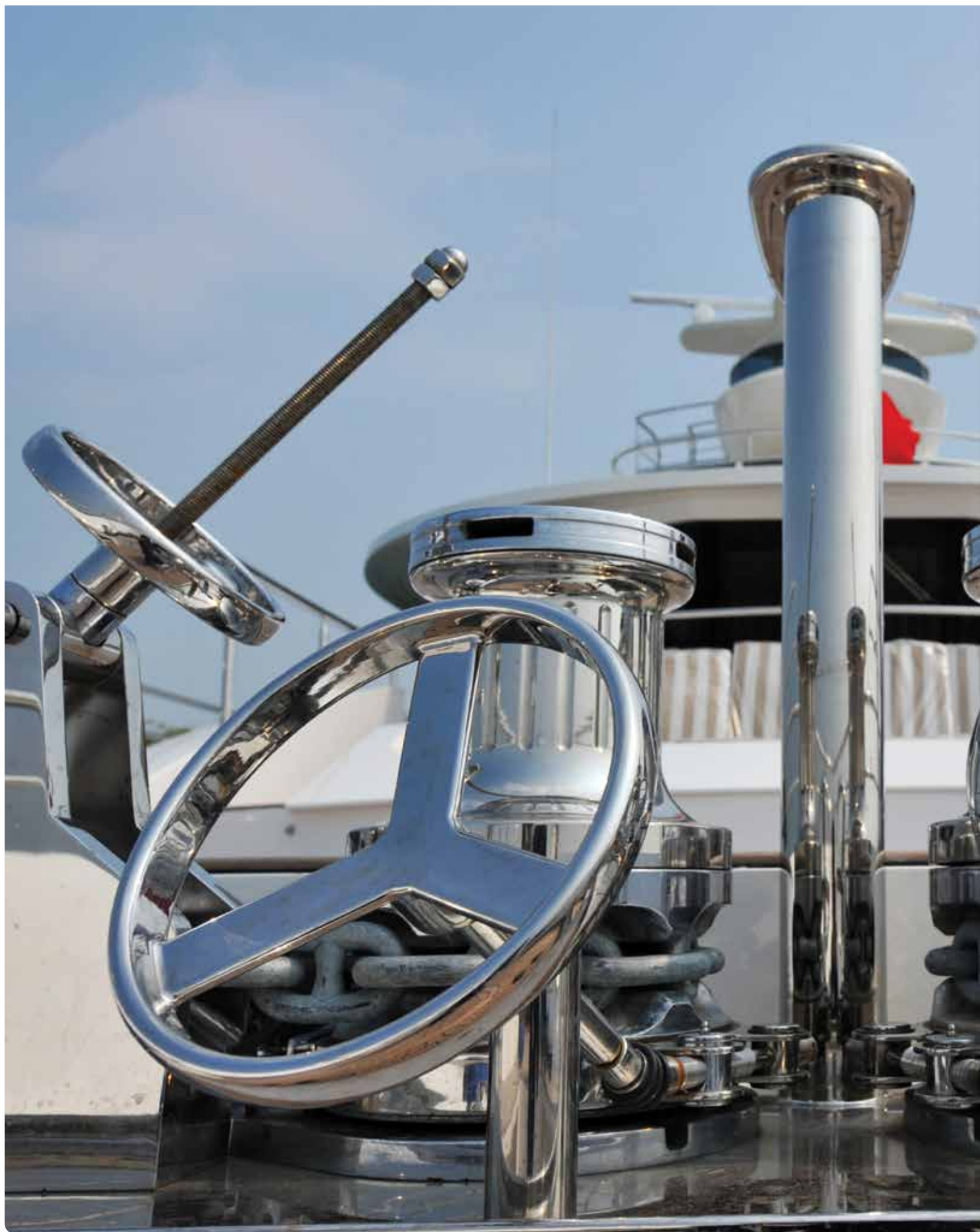



components and accessories

Control panels

Accessories

Sanisplit grey water transfer systems

Sanitation hoses

CONTROL YOUR DESIGN

CONTROL PANELS FOR EVERY BATHROOM

You are in control, to perfect match the control panel with the bathroom style.

Design line  **& Flexi line** 

> 100 ft

50-100 ft

All control panels have a tank monitoring led and water amount trim. All control panels are available in two versions:

1 button / After use:

- The mooring mode.
- After every flush the toilet bowl is automatically refilled with a certain quantity of water, ready for next use.
- Tank level monitoring led and water amount trim.

2 buttons / Before & After use:

- Both the mooring and the sailing mode.
- After every flush the toilet bowl remains empty for navigation.
- Before use by pushing the button the toilet bowl automatically refills.

Thetford Marine offers a complete portfolio with different series, multiple options and budget implications.

Smart Flush Technology

The Smart Flush technology is one of the latest patented innovations of the Tecma product line. This software interacts with the action and performance of the macerator pump and gives many features. Just a few of them:

- Eliminating air in the pump which prevents noise
- Minimizes water and power consumption
- Electronic water amount setup
- Sailing and mooring modes
- Water overflow protection
- Black water tank monitoring
- Emergency flush
- System lock

Touch SFT control panel



Touch control panel made of hi-tech glass and LED backlighting with proximity sensor. Design and high-technology combined with respect for budget.

Multiframe SFT control panel



The control panel that gives the possibility of mounting any bezel on the market, the chameleon of the control panels.

All-in-one SFT control panel



The All-in-one control panel has a controller directly integrated in the wall interface with the option of automatic bowl refill (single button) or the common double function before/after use.

Compact line

To operate the toilet of the Compact Line, it is possible to select two different control panels: the Eco Rocker Switch and the Premium plus.

Eco rocker switch



Easy to use, strong and solid rocker switch with manual set up of inlet and outlet water amount with a reduced power and water consumption.

Premium Plus control panel



Silicon pad control panel with Tecma patented Smart Flush technology. Water amount trim, overfill protection and tank monitoring. Flushing cycle and fittings specially designed for Compact line. Sailing mode function not available.

compact line 20/50 ft – technical details

Eco control panel:

Rocker switch with manual set up of inlet and outlet water amount with a reduced power and water consumption.

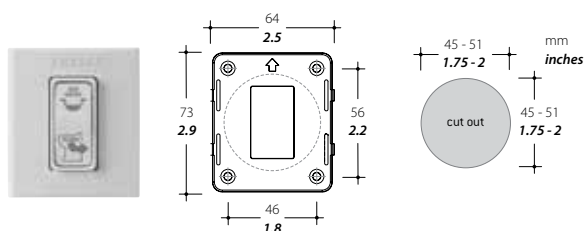

Premium Plus control panel:



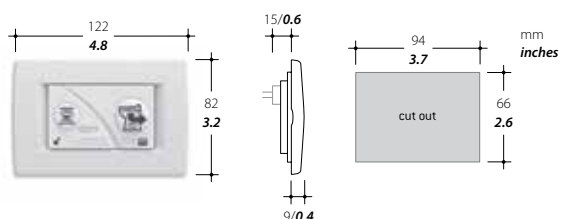

Especially designed for the Compact Line. Silicon electronic control panel. Automatic refill, water amount trim and tank monitoring.



Note: compatible with Mirus™ field effect sensor or with commercial sensor.

ACCESSORIES

THE PROVEN TECHNOLOGY

	Description
	FULL TANK SENSOR - DESIGN & FLEXI LINE Mirus™ field effect detector cell full tank sensor to monitor full tank level and communicate to the Smart Flush Premium control panel. This version is adapted for design line & flexi line.
	MID TANK SENSOR - DESIGN & FLEXI LINE Mirus™ field effect detector cell mid tank sensor to monitor mid tank level and communicate to the Smart Flush Premium control panel. This version is adapted for design line & flexi line.
	FULL TANK SENSOR - COMPACT LINE Mirus™ field effect detector cell full tank sensor to monitor full tank level and communicate to the Smart Flush Premium control panel. This version is adapted for compact line.
	MID TANK SENSOR - COMPACT LINE Mirus™ field effect detector cell mid tank sensor to monitor mid tank level and communicate to the Smart Flush Premium control panel. This version is adapted for compact line.

SANISPLIT



Sanisplit grey water transfer systems give more convenience on board

With a grey water system you create more flexibility and convenience on board. It allows you to install more sanitary appliances like a washbasin, a bidet, a shower, a dishwasher, a washing machine, on board independently of its location. The grey water system grinds and pumps it to the collection tank. This way clogging is prevented.



Sanisplit NK Above sealevel

The Sanisplit NK of Tecma is well-known in the marine market for more than 15 years.

- **Patented split system**
- **Efficient strong macerating pump**
- **Silent operation:**
 - The silent pump operation combined with the internal rubber tank reduce the sound level
- **Easy to service:**
 - The removable part of the Sanisplit, containing the pump and the pressure switch, can be rapidly disengaged from the fixed parts



Sanisplit NKS Below sealevel

Based on the technology of the Sanisplit NK, there is also a stainless steel submersible Sanisplit: the Sanisplit NKS.

- **Submersible waterproof system:**
 - Fully IP67 certified
 - Stainless steel housing
- **Proven macerator technology of Sanisplit NK**
- **Silent operation:**
 - The silent pump operation combined with the internal rubber tank reduce the sound level
- **Easy to service:**
 - Once detached any service operation is easily possible without disconnecting the hoses
- **Certified with ISO 8846:1990, for specific installation with special safety requirements**

	Sanisplit NK	Sanisplit NKS
DIMENSIONS (H X W X D)	270 x 470 x 175 mm / 10.6 x 18.5 x 6.9 inch	279 x 449 x 220 mm / 10.9 x 17.7 x 8.7 inch
BOX MATERIAL	Plastic	Stainless steel
IP LEVEL	55	67 (submersible)
OUTLET	1 outlet female DN ID40	1 outlet male DN OD38
INLET	2 inlets female DN ID40	2 inlets male DN OD38
WEIGHT	8.0 Kg / 17.6 lb	13.7 Kg / 30.2 lb
HOLD DOWN FITTING	No	Yes
INSTALLATION MIN. HEIGHT FROM SHOWER TRAY LOWEST EDGE	200 mm / 7.9 inch	180 mm / 7.1 inch
APPLIANCES	1 for max 3 appliances [1 sink + 1 bidet + 1 shower]	

Macerator pump (Sanisplit NK / Sanisplit NKS)	
POWER SUPPLY	12V DC / 24V DC / 230V AC*
FUSE RECOMMENDED (FUSE NOT INCLUDED)	12V DC 40A
	24V DC 30A
	230V AC 5A
PUMP CAPACITY	270 l / min / 71.3 gpm
MAX VERTICAL HEAD	10 m / 36.1 ft
MAX HORIZONTAL DISTANCE	90 m / 295.3 ft
MAX GREY WATER TEMPERATURE	90° C / 194° F

*Sanisplit NK only

Sanisplit NK

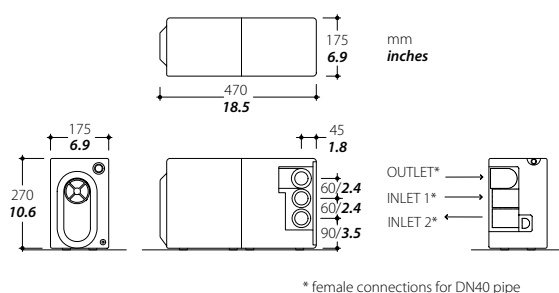

Sanisplit NKS

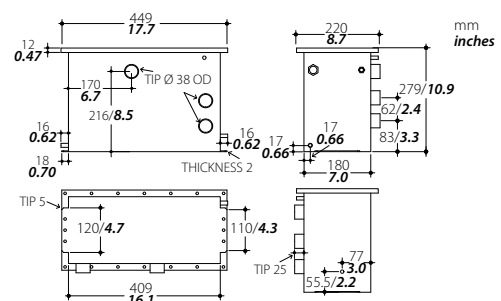

HOSEPLUS – HOSEHELIX

Sanitation hoses with the perfect match of flexibility and odor barrier



HOSEPLUS 38 Sanitation hose

- Very low permeability (<1%)
 - Special high-quality butyl rubber sanitation hose
 - Odor shield prevents the spread of odors
 - 10 times less odors than SBR/ NBR rubber hoses
- Extremely flexible
 - Flexible and strong with double steel wire helix
 - Extra strong synthetic textile yarn
- Smooth fabric finished surface
 - White cover with protective band to preserve color before installation
 - Resistant to abrasion, ozone, sea water and marine agents
 - Vanilla scented
- 5-year warranty

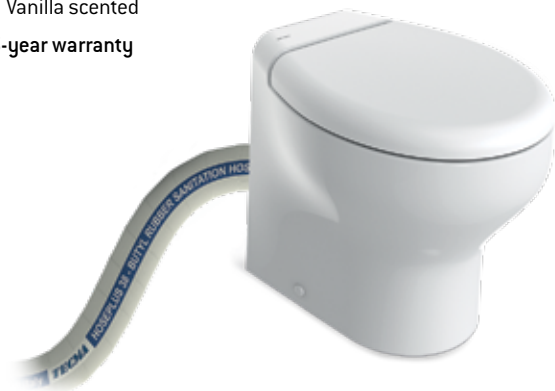

HOSEHELIX 38 Sanitation hose

- High-quality PVC sanitation hose
 - Smooth tube specially designed for marine applications
- Odor barrier
 - Limiting the spread of odors
- Very flexible
 - Flexible and strong with steel wire helix
- Smooth extruded hose
 - Resistant to weathering and most chemicals
- White cover



Tecma sanitation hoses

When it comes to marine sanitation, rely on the best quality and expertise.

Thetford Marine offers now Tecma Hoseplus and Hosehelix sanitation hoses.

High quality sanitation hoses which are extremely flexible and give you the perfect odor barrier.

HOSEPLUS 38 Sanitation hose

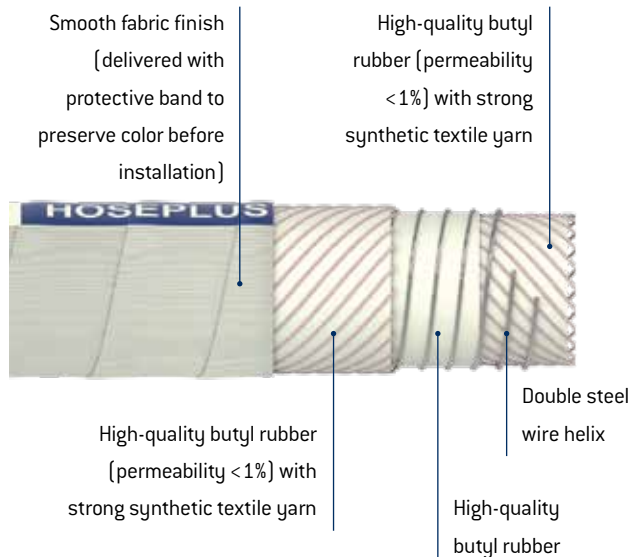

	Hoseplus 38		Hosehelix 38	
MATERIAL	Butyl rubber		PVC	
INSIDE DIAMETER	38 mm	1.5"	38 mm	1.5"
OUTSIDE DIAMETER	48 mm	1.9"	43 mm	1.7"
WEIGHT	0.85 kg/ mt	0.57 lbs/ ft	0.9 kg/ mt	0.6 lbs/ ft
WORKING PRESSURE	7 bar	105 psi	4 bar	60 psi
BURST PRESSURE	21 bar	315 psi	n.a.	n.a.
VACUUM	0.9 bar	13 psi	0.8 bar	12 psi
BENDING RADIUS	80 mm	3.1"	115 mm	4.5"
LENGTH	15 mt	50 ft	15 mt	50 ft

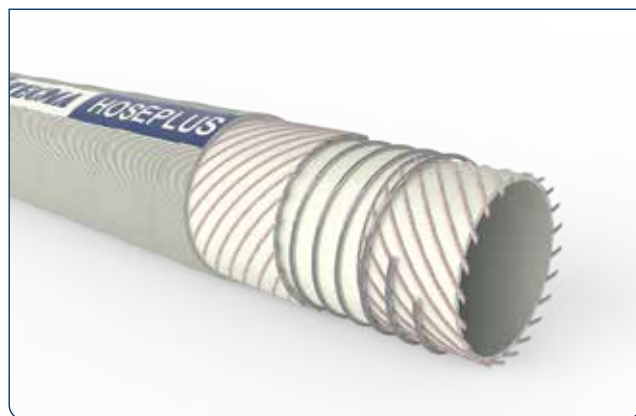

Hoseplus 38

HOSEHELIX 38 Sanitation hose

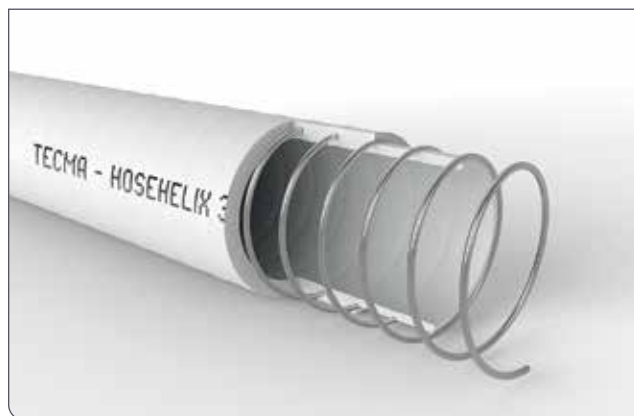
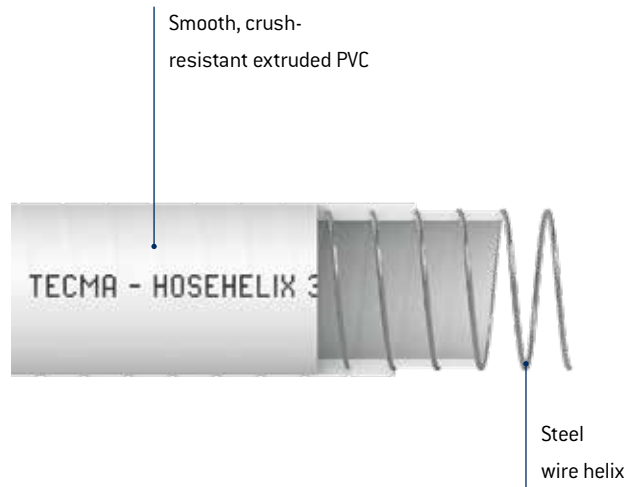

Hosehelix 38





system set up

SYSTEM SET UP

The clean water that will flush the toilet is supplied by a dedicated pump that usually is connected either to a fresh water tank or through-hull. When the control panel is activated the pump will start working to deliver clean water inside the toilet bowl.

Single system

Plumbing

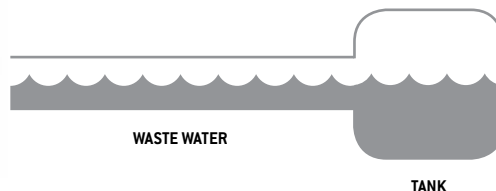

Wiring - All in one panel

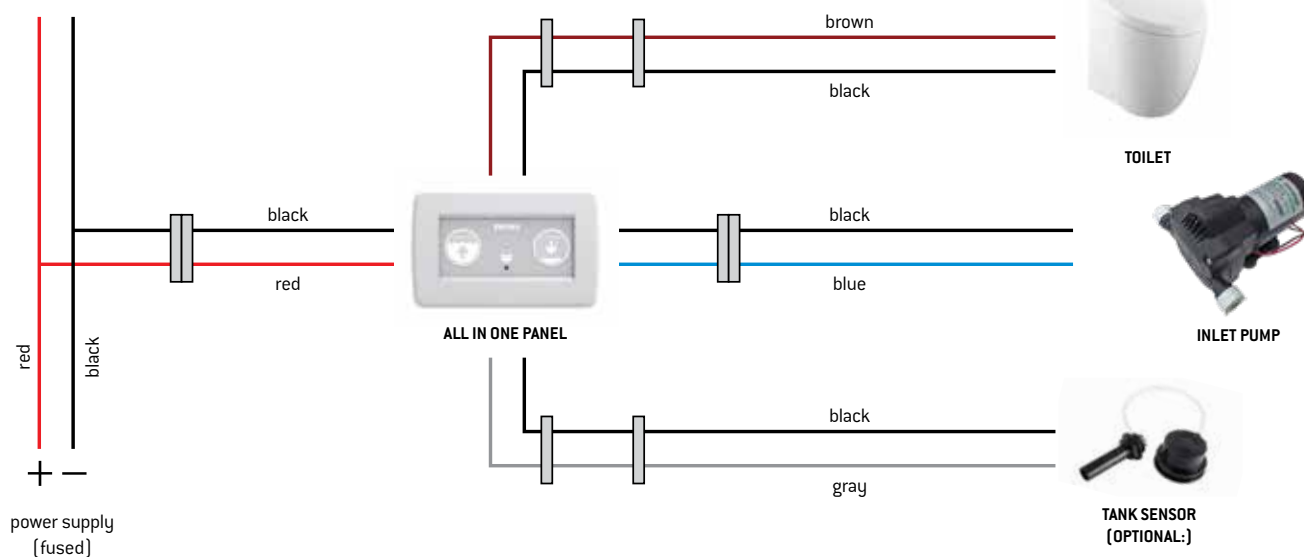

When is a siphon break needed?

Must have with below water line installation

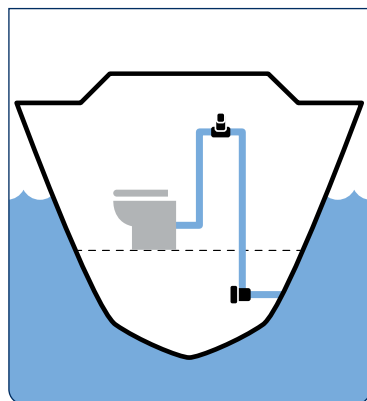

Must have for sailing boats

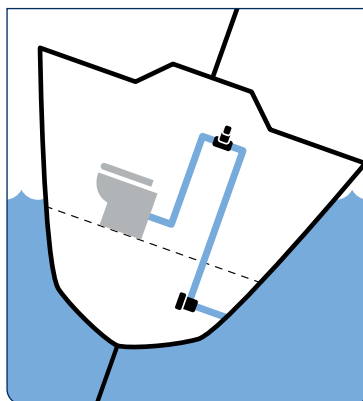

Recommended: multiple connection and long runs of collector hose

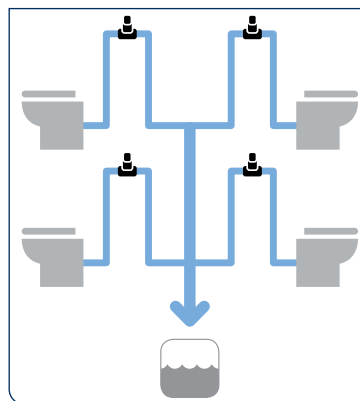

Central system fresh water

The clean water that will flush the toilet, is supplied by a central pumping device or accumulator, that is connected either to a fresh water tank. Each toilet has a dedicated solenoid. When the control panel is activated the solenoid will open the gear to supply clean water inside the bowl.

Q: Is it possible to connect more toilets to the same line?

A: Yes. In this case a "Y" fitting is needed, in spite of "T" ones, to drive the flow to the tank. Always add a siphon break to prevent siphoning.

Fresh water plumbing

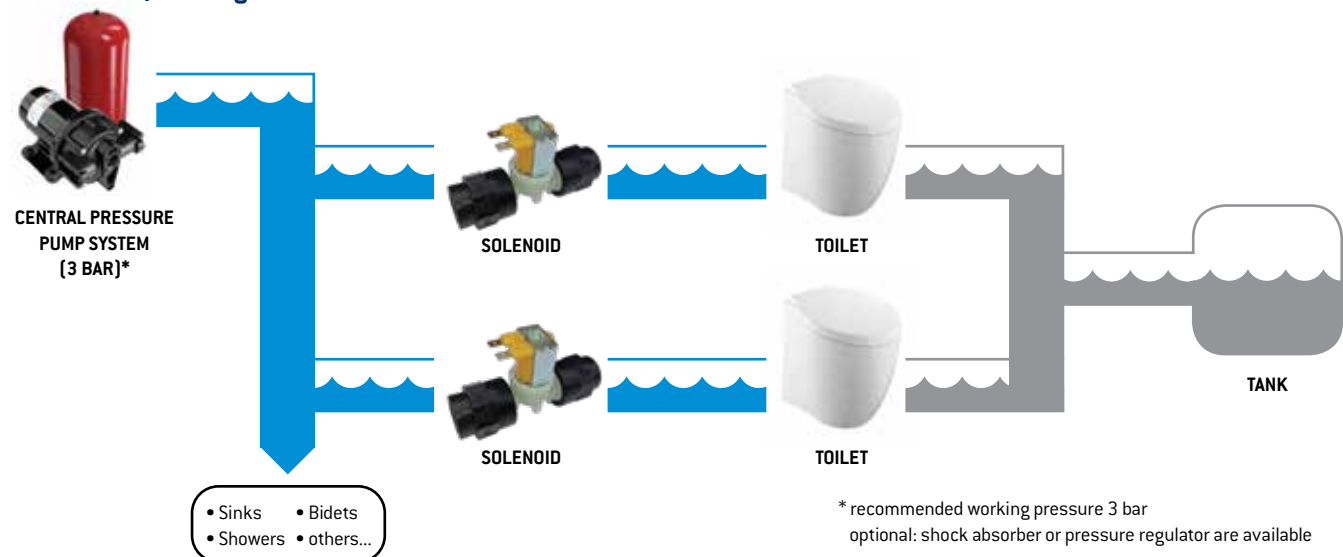

Fresh water wiring - All in one panel

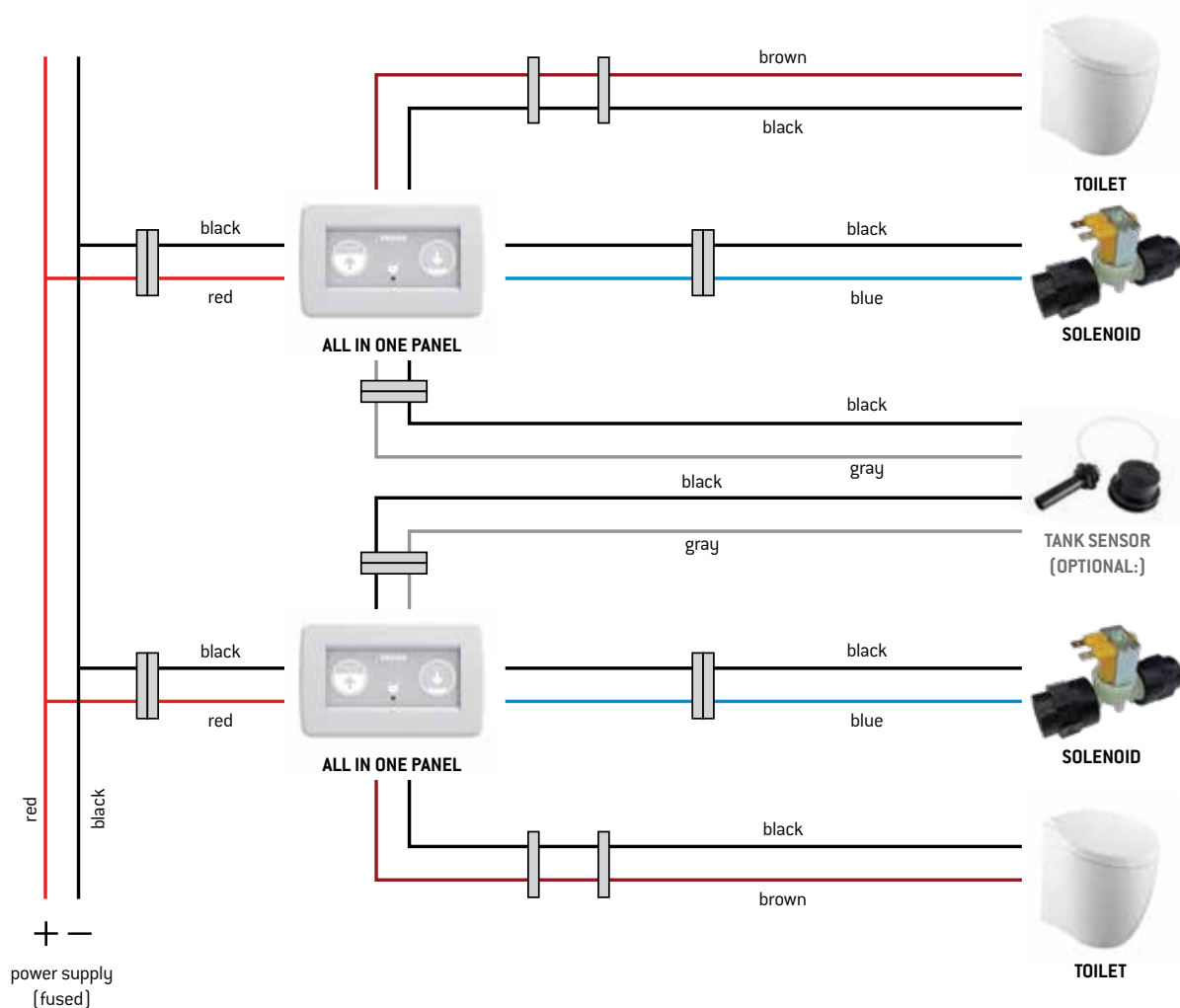

Compact wiring

Eco rocker switch

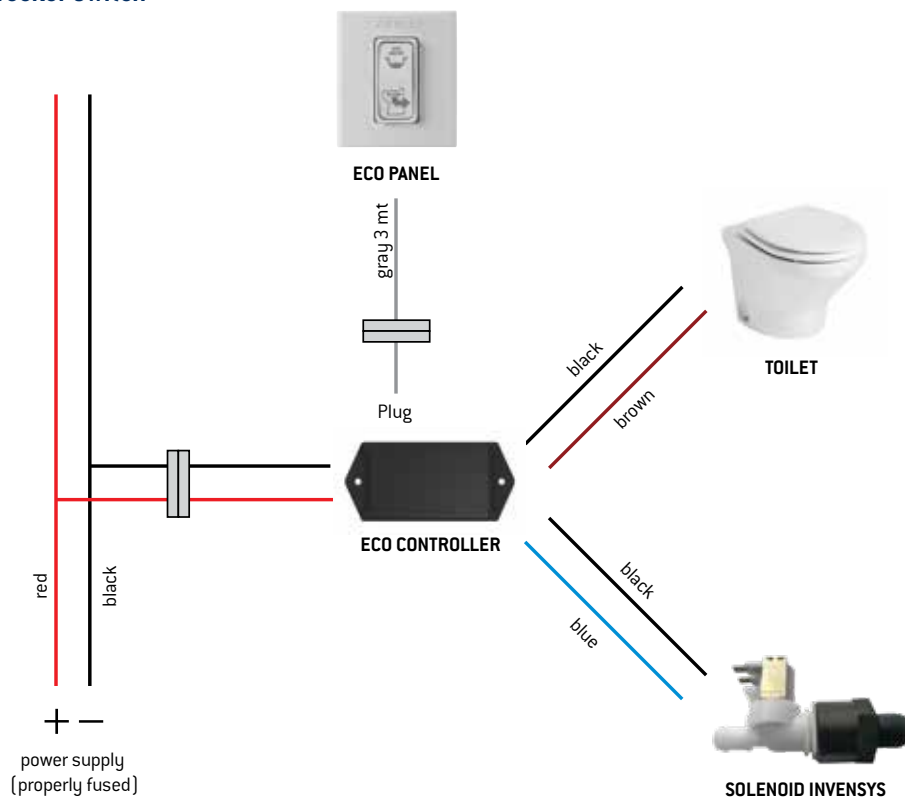

Premium plus

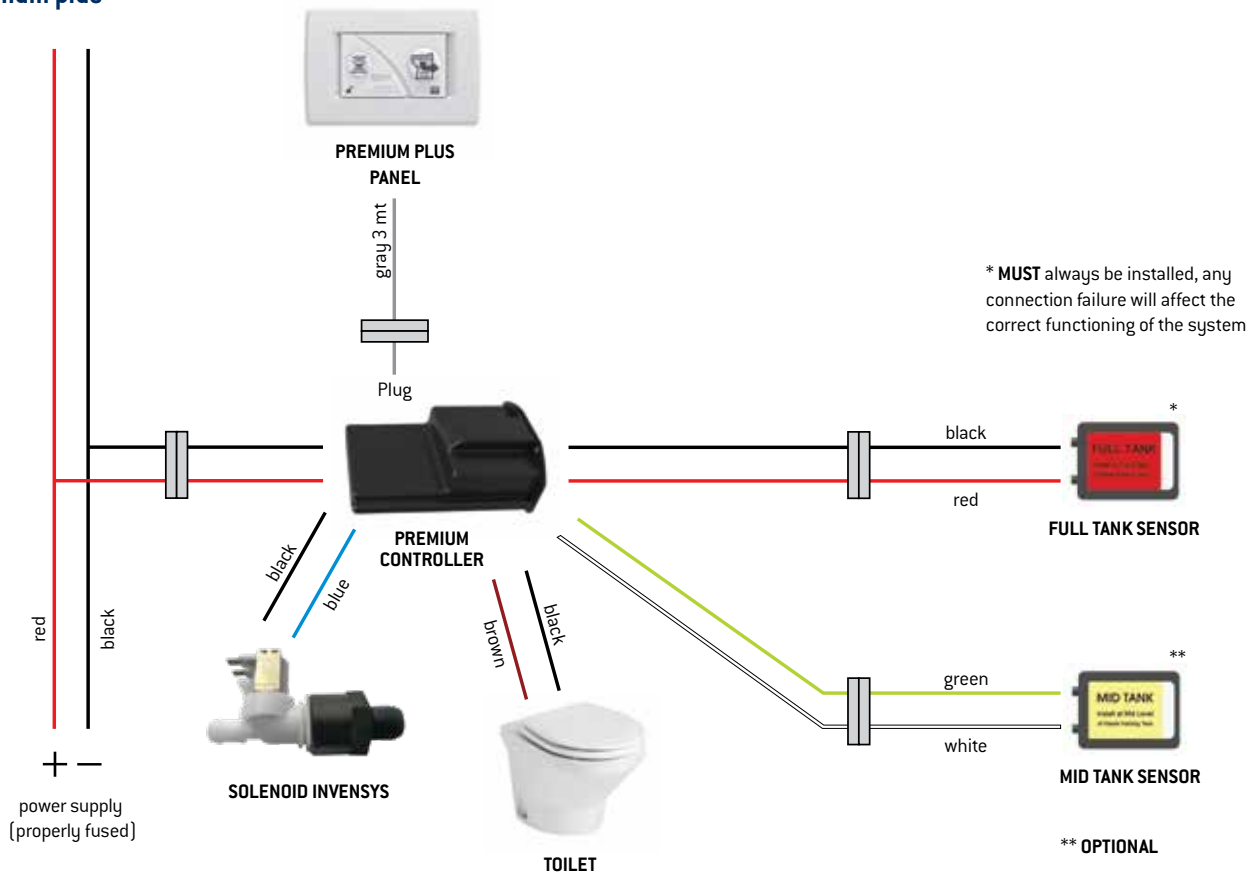



UNITED STATES OF AMERICA

Thetford Corporation
7101 Jackson Road
Ann Arbor, Michigan 48103
U.S.A.

(734) 769-6000
info@thetford.com



*For more information or to find your nearest
Thetford Marine dealer or service location check*
www.thetfordmarine.com